

**Kings Island Developments Ltd**  
1 Northbrook Road, Ranelagh,  
Dublin 6.

Telephone: 4962955

E-mail: info@oraltd.com

To whom it may concern

**King's Island Flood Relief Scheme**  
**Letter of consent to lodge planning application with An Bord Pleanála**

Dear Sir/Madam,

Kings Island Development Ltd, 1 Northbrook, Ranelagh, Dublin 6 is the owner of the site opposite the Absolute Hotel on Sir Harry's Mall and lands at Grove Island, as shown outlined in blue on the attached drawing. The company has been in discussions with Limerick City and County Council over the optimum design of the King's Island flood defence scheme as it impacts the Absolute Hotel. Kings Island Development Ltd hereby consents to:-

- (i) provision of access to lands at Grove Island to facilitate launching of barge and piling rig into Abbey River
- (ii) provision of portion of lands at the corner of Sir Harry's Mall opposite Absolute Hotel, to provide for setting back of footpath and carriageway, to facilitate provision of bus parking and traffic turning movements at the corner

These works has been agreed between Kings Island Development Ltd and Limerick City and County Council as the optimum design solution.

Kings Island Development Ltd consents to Limerick City and County Council lodging planning application to An Bord Pleanála on these lands.

Name	Jerry O'Reilly
Position	Company Director
Signature	
Date	<u>23 / 10 / 2019</u>



Athlunkard Boat Club

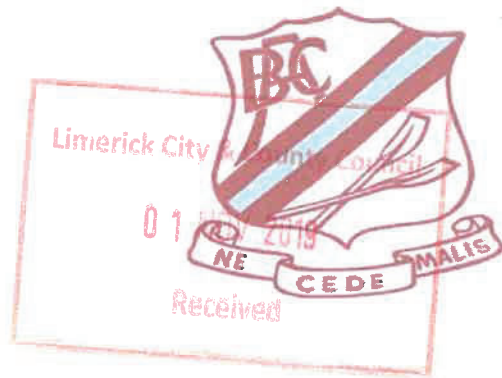

**King's Island Flood Relief Scheme**  
**Letter of consent to lodge planning application with An Bord Pleanála**

Dear Sir/Madam,

Athlunkard Boat Club is the owner of lands at Athlunkard Street, Limerick as shown outlined in blue on the attached drawing. Athlunkard Boat Club has been in discussions with Limerick City and County Council over the optimum design of the King's Island flood defence scheme. These works include the construction of a flood defence wall/boundary wall along the west side of the site, relocation of vehicular entrance and provision of new gates, construction of internal access road and yard, provision of new foul sewer connection, refurbishment of meeting room in clubhouse and individual property protection to both buildings. These works are agreed between Athlunkard Boat Club and Limerick City and County Council as the optimum design solution.

Athlunkard Boat Club consents to Limerick City and County Council lodging planning application to An Bord Pleanála on Athlunkard Boat Club lands.

Name  
Position  
Signature  
Date

Print Name **MIKE KIELY**  
Print Title **HON SECRETARY**  
*Mike Kiely*  
29/10/2019





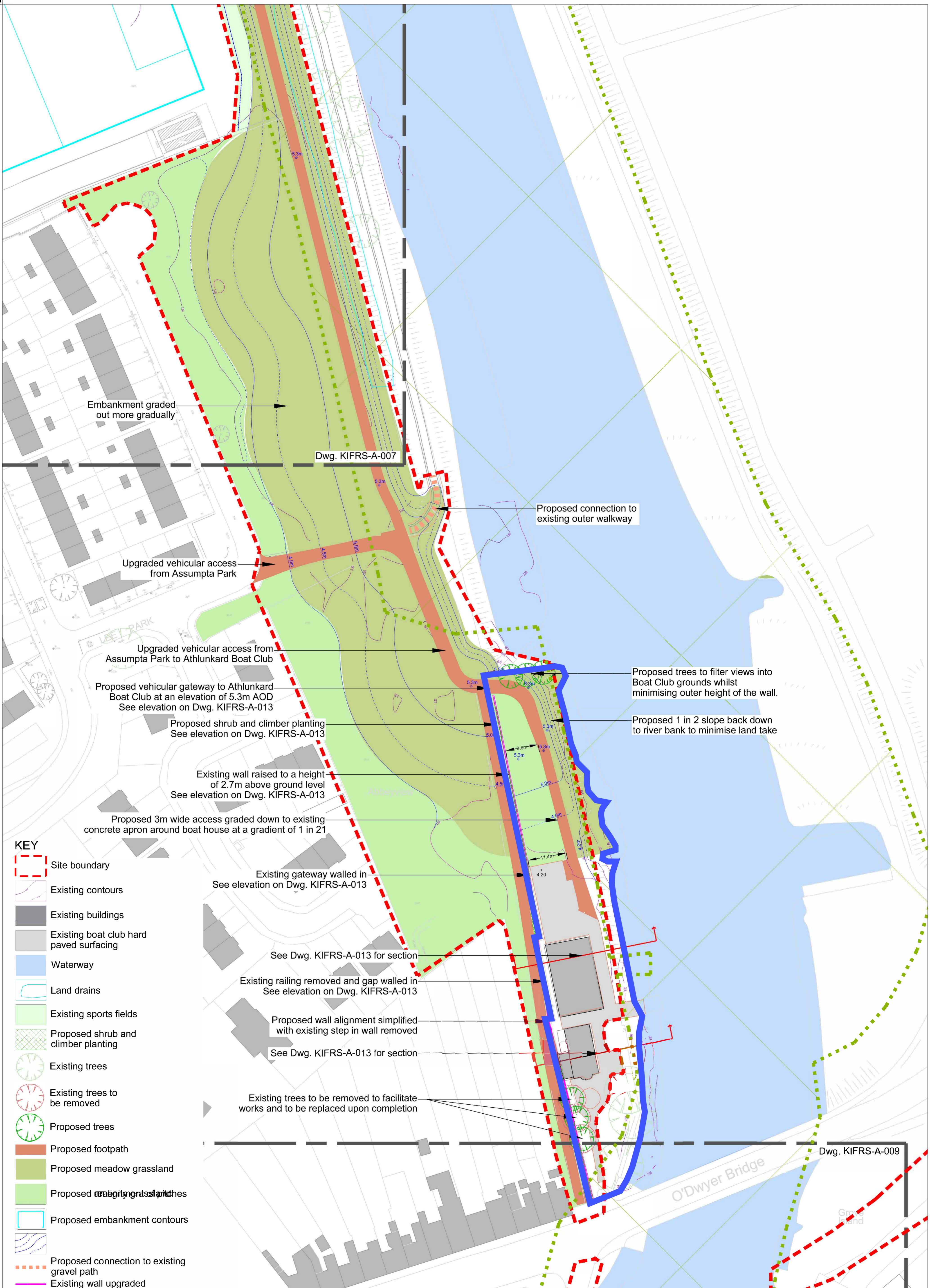

Embankment graded out more gradually

Dwg. KIFRS-A-007

Proposed connection to existing outer walkway

Upgraded vehicular access from Assumpta Park

Upgraded vehicular access from Assumpta Park to Athlunkard Boat Club

Proposed vehicular gateway to Athlunkard Boat Club at an elevation of 5.3m AOD See elevation on Dwg. KIFRS-A-013

Proposed shrub and climber planting See elevation on Dwg. KIFRS-A-013

Existing wall raised to a height of 2.7m above ground level See elevation on Dwg. KIFRS-A-013

Proposed 3m wide access graded down to existing concrete apron around boat house at a gradient of 1 in 21

Proposed trees to filter views into Boat Club grounds whilst minimising outer height of the wall.

Proposed 1 in 2 slope back down to river bank to minimise land take

Existing gateway walled in See elevation on Dwg. KIFRS-A-013

See Dwg. KIFRS-A-013 for section

Existing railing removed and gap walled in See elevation on Dwg. KIFRS-A-013

Proposed wall alignment simplified with existing step in wall removed

See Dwg. KIFRS-A-013 for section

Existing trees to be removed to facilitate works and to be replaced upon completion

Dwg. KIFRS-A-009

KEY

- Site boundary
- Existing contours
- Existing buildings
- Existing boat club hard paved surfacing
- Waterway
- Land drains
- Existing sports fields
- Proposed shrub and climber planting
- Existing trees
- Existing trees to be removed
- Proposed trees
- Proposed footpath
- Proposed meadow grassland
- Proposed meadow grassland with paths
- Proposed embankment contours
- Proposed connection to existing gravel path
- Existing wall upgraded

**JBA consulting**

Nicholas de Jong Associates  
URBAN DESIGN

F	08.10.19	SMCK	SMCK	SMCK
E	01.10.19	SMCK	SMCK	SMCK
D	23.08.19	SMCK	SMCK	SMCK
C	28.06.19	SMCK	SMCK	SMCK
B	12.06.19	SMCK	SMCK	SMCK
A	19.04.19	SMCK	SMCK	SMCK
-	08.03.19	SMCK	SMCK	SMCK
Issue	Date	By	Chkd	Appd

Client  
Limerick City & County Council  
Comhairle Cathrach & Contae Luimnigh  
Limerick City & County Council

Job Title  
**KING'S ISLAND**  
FLOOD RELIEF SCHEME

Scale at A1  
1:500

Discipline

**ARUP**

Arup, 50 Ringsend Road  
Dublin, D04 T6X0  
Tel +353(0)1 233 4455 Fax +353(0)1 668 3169  
www.arup.ie

Drawing Title  
KIFRS Proposals Layout  
Sheet 7 of 10  
Areas A4 & A5

Job No  
**KIFRS**

Drawing Status  
**DRAFT**

Drawing No  
**KIFRS-A-008**

Issue  
**F**



To whom it may concern

**King's Island Flood Relief Scheme**  
**Letter of consent to lodge planning application with An Bord Pleanála**

Dear Sir/Madam,

Athlunkard Football Club is a leaseholder of lands from Limerick City and County Council and operates a football pitch in St. Mary's Park, as shown outlined in blue on the attached drawing. Athlunkard Football Club has been in discussion with Limerick City and County Council over the optimum design of the flood embankment as it affects the playing pitch. The proposed embankment design and layout is agreed between Athlunkard Football Club and Limerick City and County Council as the optimum solution.

Athlunkard Football Club consents to Limerick City and County Council lodging a planning application to An Bord Pleanála on these lands.

Print Name: Dr. James Ring

Position: Athlunkard Vice Chairman



Signature:

Date: 9<sup>th</sup> November 2019

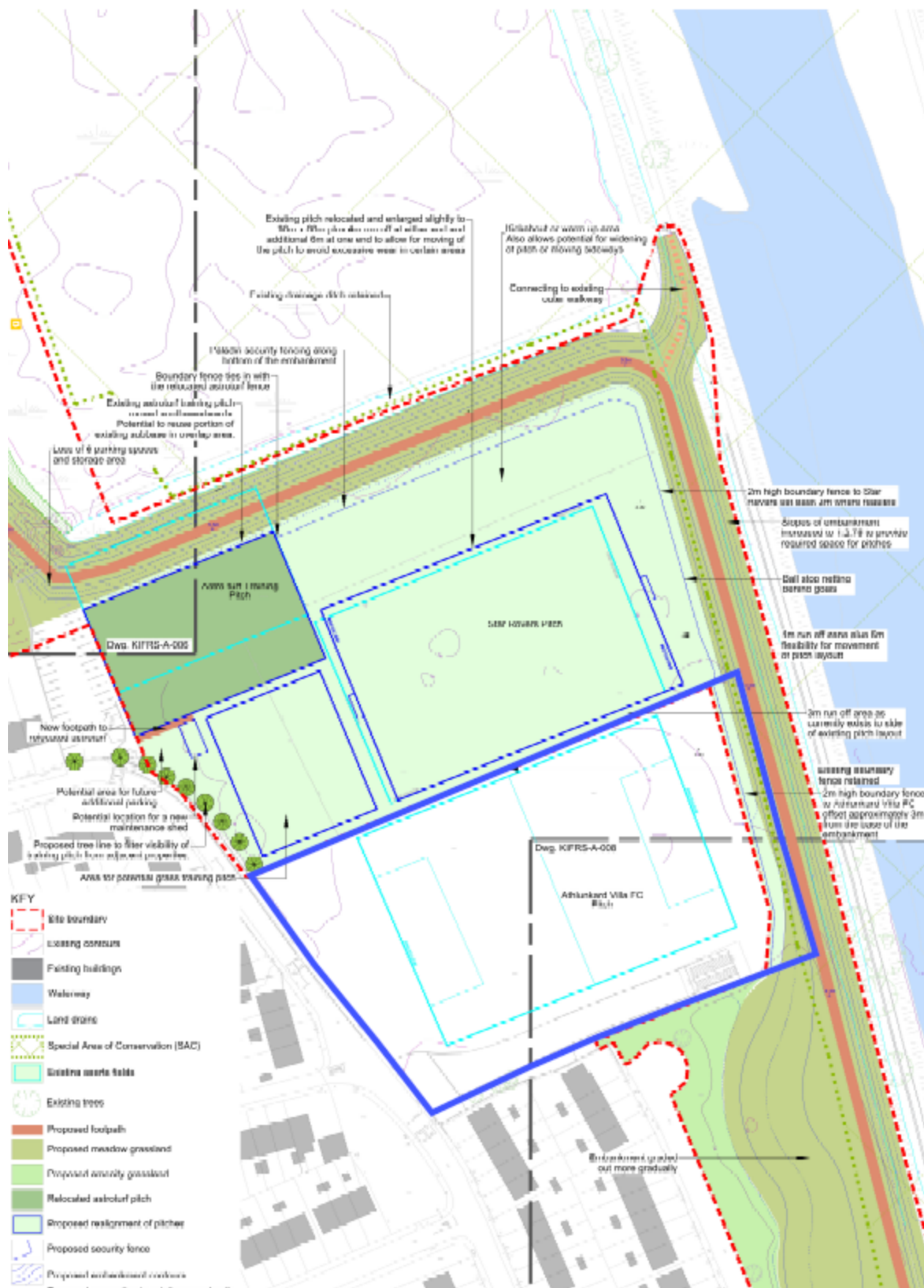



# STAR ROVERS AFC

## King's Island Flood Relief Scheme

### Letter of consent to lodge planning application with An Bord Pleanála

Dear Sir/Madam,

Star Rovers Football Club is a leaseholder of lands from Limerick City and County Council at St. Mary's Park, as shown outlined in blue on the attached drawing. Star Rovers Football Club has been in discussions with Limerick City and County Council over the optimum design of the flood defence scheme as it affects the astra turf and grass playing pitches. The proposed embankment design, layout and reorganisation of the pitches is agreed between Star Rovers and Limerick City and County Council as the optimum solution.

Star Rovers Football Club consents to Limerick City and County Council lodging a planning application to An Bord Pleanála on these lands.

Name

MARTIN O'BRIEN

Position

CHAIRMAN

Signature

Martin O'Brien

Date

19. 11. 19