

MEADOWBROOK - ROAD CLOSURE SECTION 3

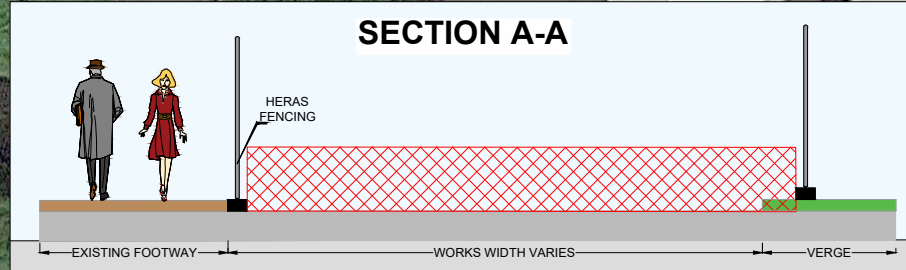

DESIGN PARAMETERS	
CHAPTER 8 ROAD LEVEL:	1(III)
SPEED LIMIT:	50km/h
ROADWORKS TYPE:	B
NUMBER OF AWS:	2
SIGN VISIBILITY:	50m
DISTANCE BETWEEN SIGNS:	20m
SIGNS SIZE RECTANGULAR - MIN.:	600mm
SIGNS SIZE CIRCULAR - MIN.:	600mm
CONE HEIGHT - MIN.:	750mm
TAPER CONE SPACING:	1m
LONGITUDINAL CONE SPACING:	3m
RATE OF TAPER:	LANE - N/A; HS - N/A
SAFETY ZONE:	LONGITUDINAL - N/A; LATERAL 0.5m
UNOBSTRUCTED WIDTH:	N/A
MAXIMUM LENGTH OF SHUTTLE:	200m
MINIMUM LANE WIDTH:	3m
TM SYSTEM:	ROAD CLOSURE

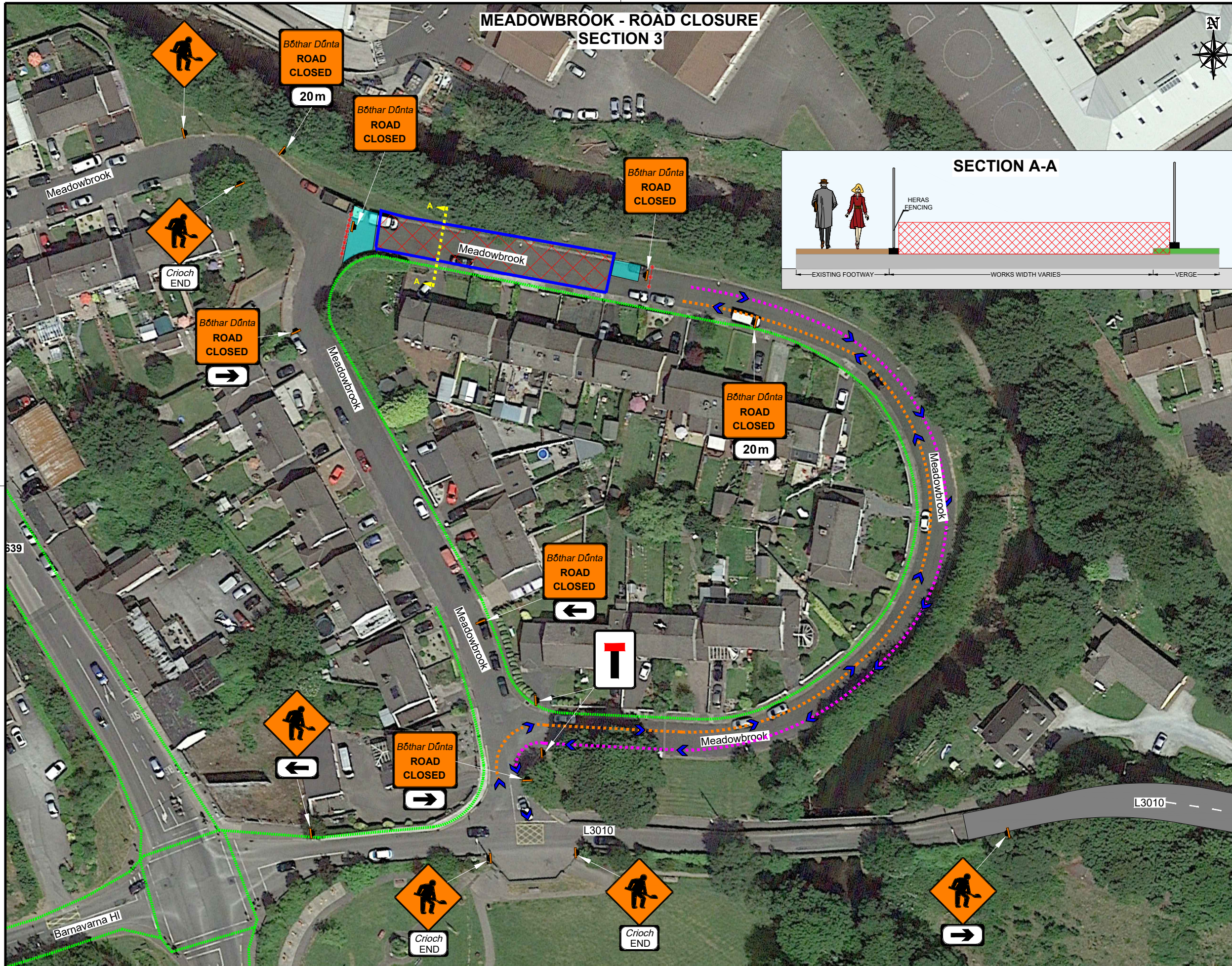
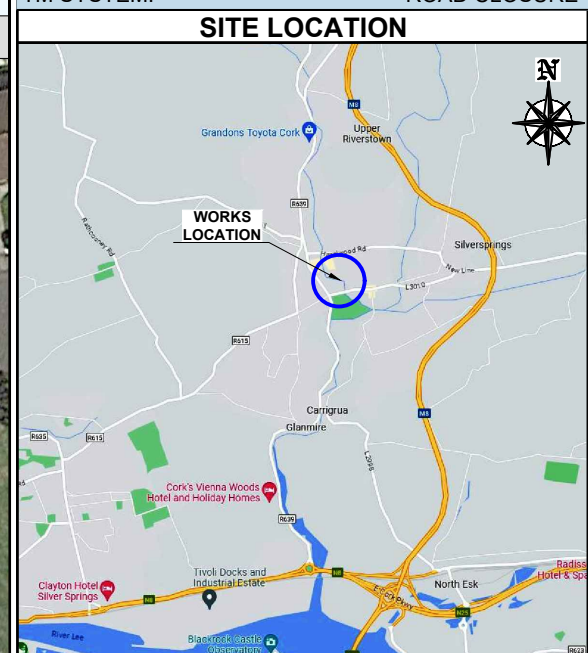

SITE SPECIFIC NOTES

a) Exact temporary sign location to be assessed and installed on site by TTOS
 b) Local residents to be notified of restrictions and road closures.

LEGEND

	- TEMPORARY TRAFFIC SIGN		- DIVERTED ROUTE 1
	- TRAFFIC CONES		- DIVERTED ROUTE 2
	- SAFETY ZONE		
	- WORKS AREA		
	- PEDESTRIAN ROUTE		
	- HERAS FENCING OR SIMILAR		

REV	DESCRIPTION	DATE	REV BY	CHK BY

CLIENT: **SORENSEN**

PROJECT: **GLASHABOY FLOOD RELIEF SCHEME GLANMIRE, CO.CORK**

TITLE: **MEADOWBROOK ROAD CLOSURE SECTION 3**

DIRECTOR:	BE	PM:	EP	CHECKED:	EP
SCALE:	NTS	DRAWN BY:	EB	DATE:	16/11/23
STAGE:	CONSTRUCTION			A3 (297x420mm)	
DRAWING NO.:	EN 6765 - 000 - 025			REV:	00

UNIT 28, SECOND AVE
 COOKSTOWN IND. EST.
 TALLAGHT, D24, IRELAND
 TEL: (01) 424 2070
 EMAIL: info@chmtd.ie
 WEB: www.chmtd.ie

UNIT 6, WATERGRASSHILL
 BUSINESS PARK,
 CO. CORK, T56 TD42
 TEL: +353868118317

GENERAL NOTES

- THIS TRAFFIC MANAGEMENT PLAN MAY ONLY BE IMPLEMENTED BY A TEMPORARY TRAFFIC OPERATIONS SUPERVISOR (TTOS) WHO MUST CARRY OUT A SITE RISK ASSESSMENT TO MODIFY (IF NECESSARY) THE MEASURES DESCRIBED TO SUIT ACTUAL SITE CONDITIONS BEFORE IMPLEMENTATION.
- THE TTOS MUST BE IN POSSESSION OF THE VALID CONSTRUCTION SKILLS REGISTRATION CARD SIGNING, LIGHTING, AND GUARDING AT ROADWORKS' CONSTRUCTION REGULATIONS, 2006 AND 2013-2021 CONSTRUCTION REGULATIONS.
- THE TTOS TO DETERMINE EXACT POSITION OF SIGNS CONSIDERING THE SITE SPECIFICS.

- IN ORDER THAT THE REQUIREMENTS SET OUT IN SECTION 17(2) OF THE SAFETY, HEALTH & WELFARE ACT (2005) AND SECTION 10 OF THE CONSTRUCTION REGULATIONS (2013-2021) ARE MET, THE PSCS MUST ADVISE THE PSDP AND ALL RELEVANT PARTIES OF ANY CHANGE TO THE TEMPORARY TRAFFIC MANAGEMENT PLAN.
- ALL WORKS ARE TO BE CARRIED OUT IN ACCORDANCE WITH LOCAL AUTHORITY REQUIREMENTS AND TO BE INCLUDED IN THE SITE SPECIFIC SAFETY & HEALTH PLAN.
- MAINTENANCE CHECKS SHOULD BE CARRIED OUT AT REGULAR INTERVALS AND IN ACCORDANCE WITH CONTRACT SPECIFICATIONS.

- TEMPORARY TRAFFIC OPERATIONS SUPERVISOR TO CARRY OUT A SITE RISK ASSESSMENT PRIOR TO THE INSTALLATION OF THE TRAFFIC MANAGEMENT PLAN TO ENSURE THAT CONDITIONS REFLECT THOSE CONSIDERED FOR DESIGN POST SUBMISSION.
- ALL SIGNS, USED FOR THIS TRAFFIC MANAGEMENT PLAN MUST COMPLY WITH CHAPTER 8 OF TRAFFIC SIGNS MANUAL LATEST EDITION.
- WK 052 THIS SIGN SHOULD BE USED TO INDICATE THE POSITION OF A SITE ENTRANCE AND/OR EXIT. REFER TO CH. 8 FOR USAGE.
- BANKS MEN TO MANAGE SITE ACCESS & EGRESS.
- IF SAFETY BARRIERS USED THIS MUST COMPLY WITH TII DN-REQ-03034-1 IS EN 1317-1 E) TEMPORARY SAFETY BARRIER THE APPROACH LENGTHS TO TERMINALS MUST BE KEPT CLEAR, AND NO WORKS SHOULD BE UNDERTAKEN IN THAT EXCLUSION ZONE AND SAFETY ZONE.

- THE CONTRACTOR SHALL BE RESPONSIBLE FOR PROVIDING ALL REQUIRED RAMP ACCESS TO ALL CHANGES IN ROAD SURFACE LEVEL WHERE TRAFFIC RUNS ON A TEMPORARY SURFACE AND ALSO FOR CYCLE/PEDESTRIAN RAMPS WHERE THERE IS A LEVEL DISCONTINUITY AS A RESULT OF THE WORKS ON CYCLE PATHS & FOOTPATHS
- ADDITIONAL SIGNS MAY BE USED TO COMPLEMENT THE SPECIFIC SIGNS USED AT THE ROADWORKS: WARNING SIGNS - YELLOW BACKGROUND - DESCRIBED IN CHAPTER 6, REGULATORY SIGNS - DESCRIBED IN CHAPTER 5, ETC. THEY ALL MUST COMPLY WITH THE SPECIFICATIONS OF TRAFFIC SIGNS MANUAL AND TS4: GUIDELINES, CERTIFICATION SCHEME AND SPECIFICATION FOR CONSTRUCTION OF TRAFFIC SIGNS.
- SET BACK TO BE MAINTAINED FROM TEMPORARY SIGN TO LIVE CARRIAGEWAY AS SET OUT ON CHAPTER 8 AND TTM OPERATIONS GUIDANCE
- ALL INFORMATION CONTAINED IN THIS DRAWING SHOULD BE CHECKED VERIFIED AND APPROVED PRIOR TO ANY STAGE OF CONSTRUCTION.