

FFS\_G10 (Ballineary WWTP) Scale 1:1000 at A1  
Scale 1:2000 at A3

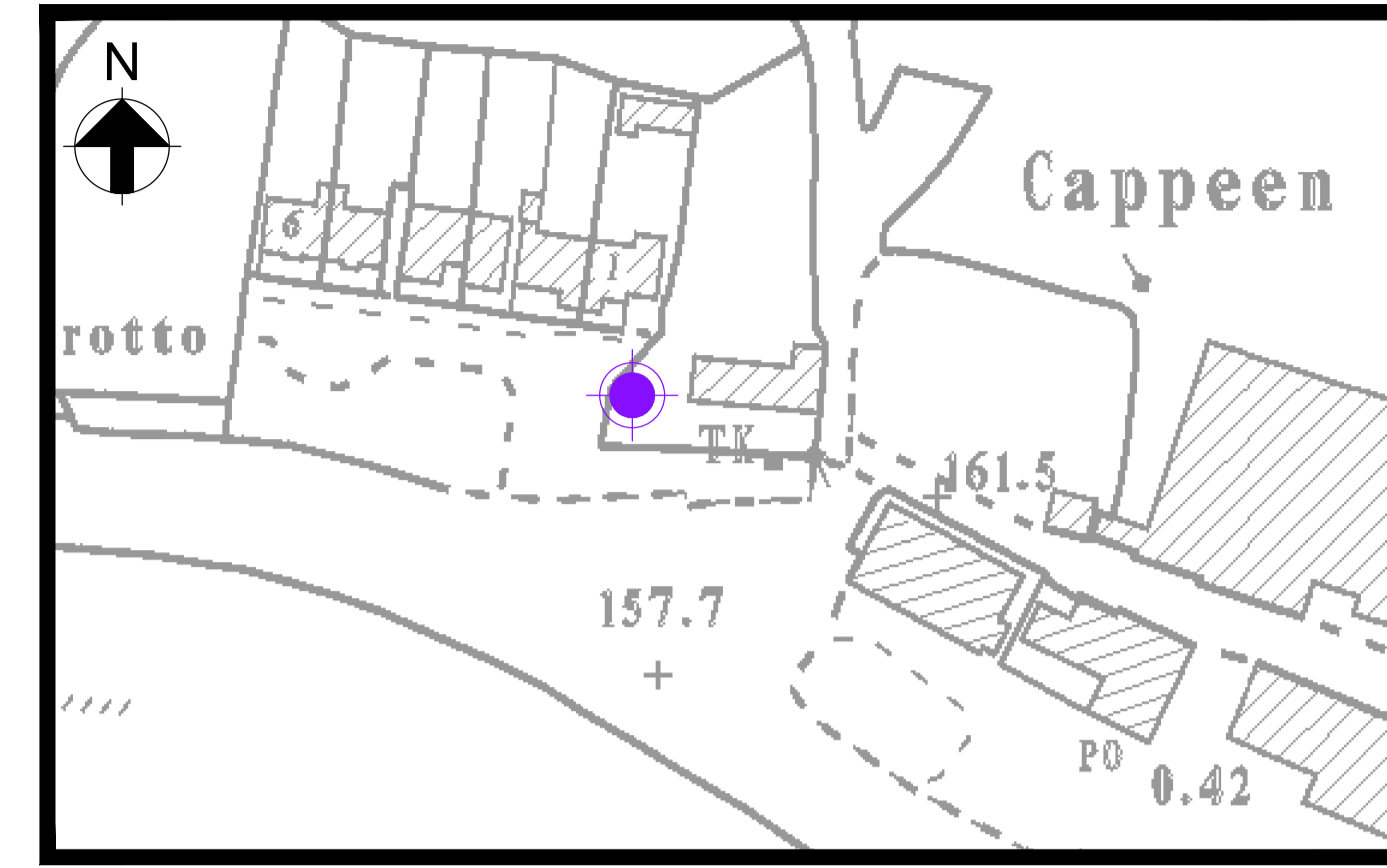

FFS\_G11 (Coolea Pumphouse) Scale 1:2000 at A1  
Scale 1:4000 at A3



FFS\_G12 (Cappeen Pumphouse) Scale 1:1000 at A1  
Scale 1:2000 at A3

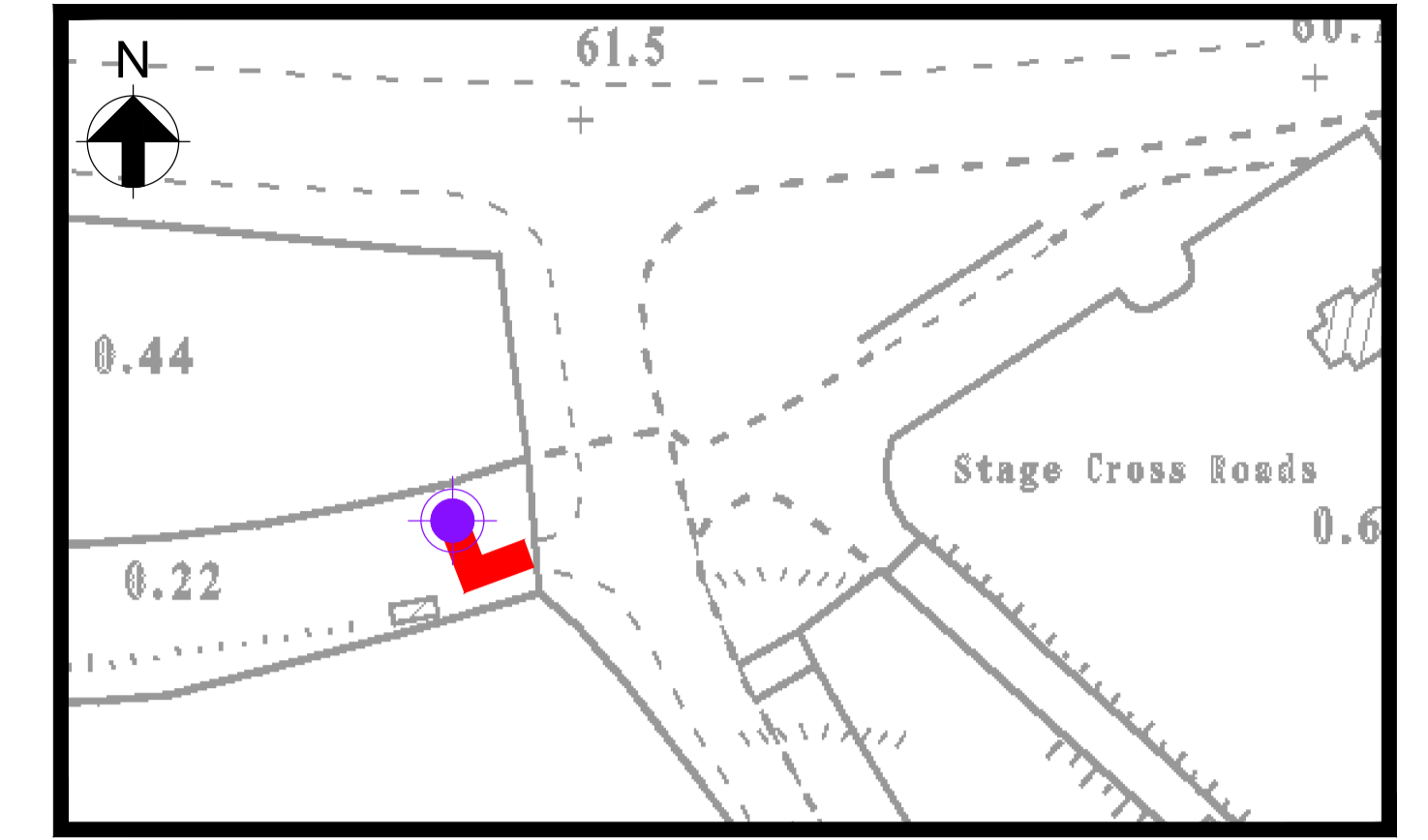

FFS\_G13 (Crookstown Pumphouse) Scale 1:1000 at A1  
Scale 1:2000 at A3

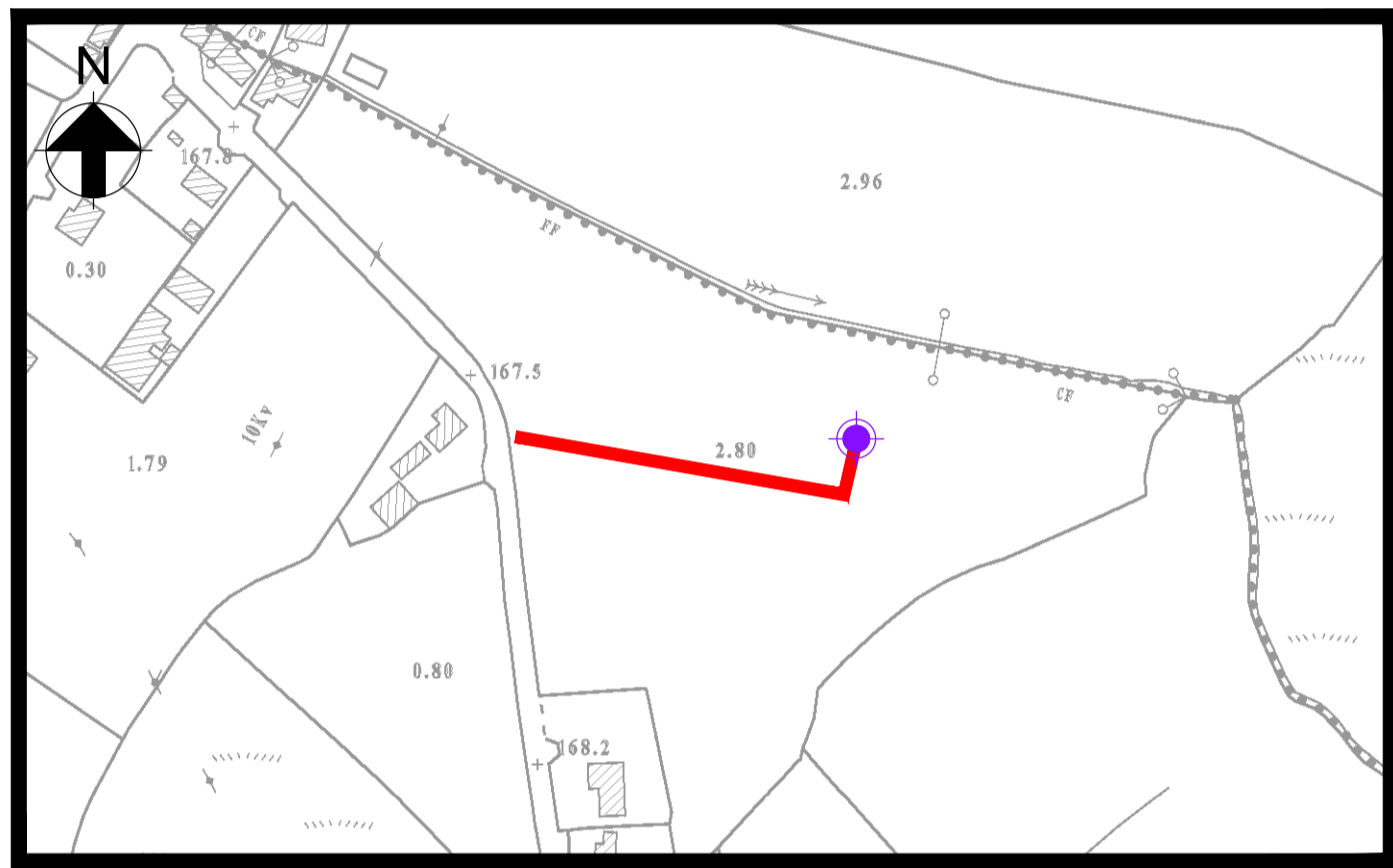

FFS\_14 (Rylane WWTP) Scale 1:2500 at A1  
Scale 1:5000 at A3

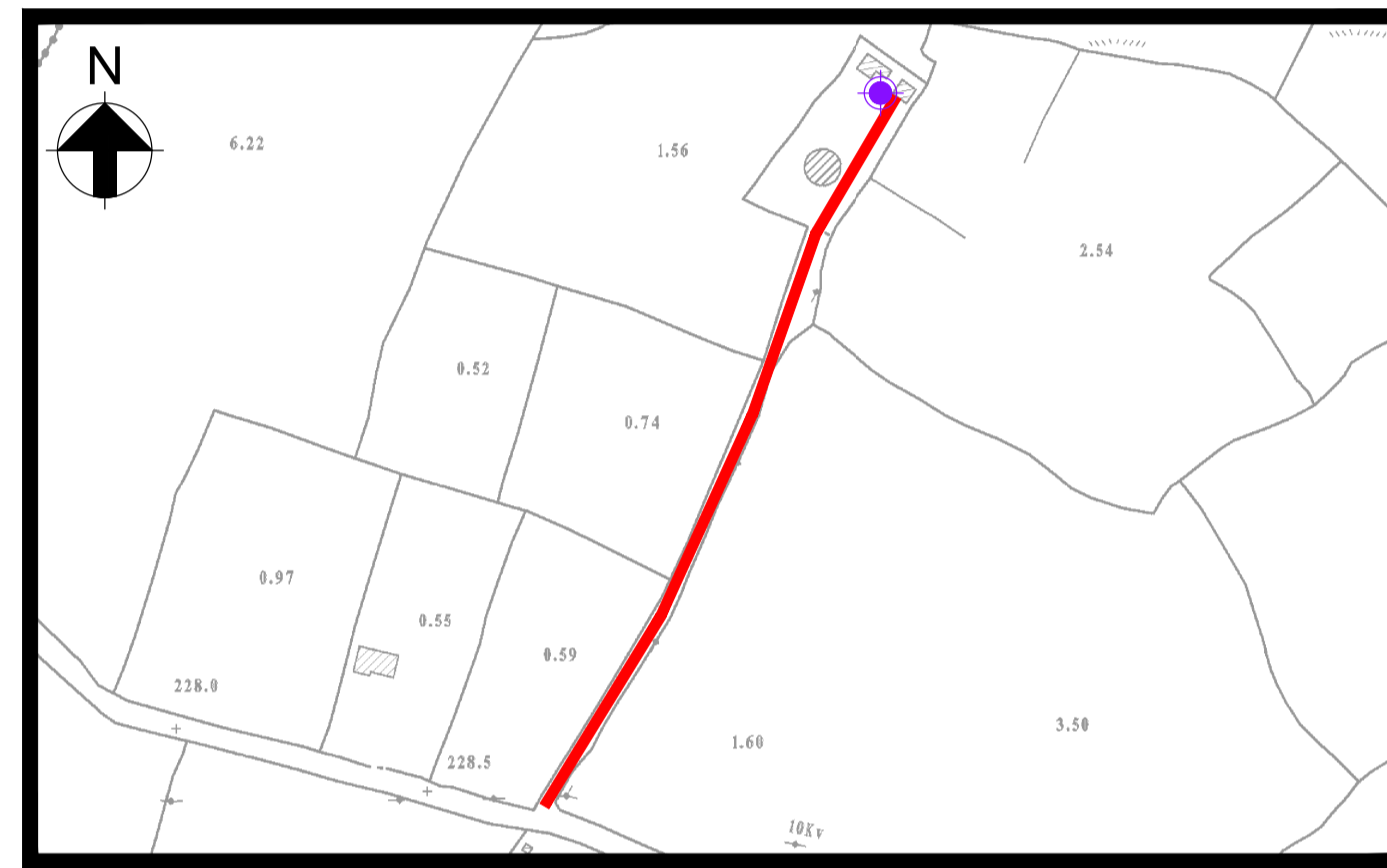

FFS\_G15 (Knockarourke Reservoir) Scale 1:3000 at A1  
Scale 1:6000 at A3

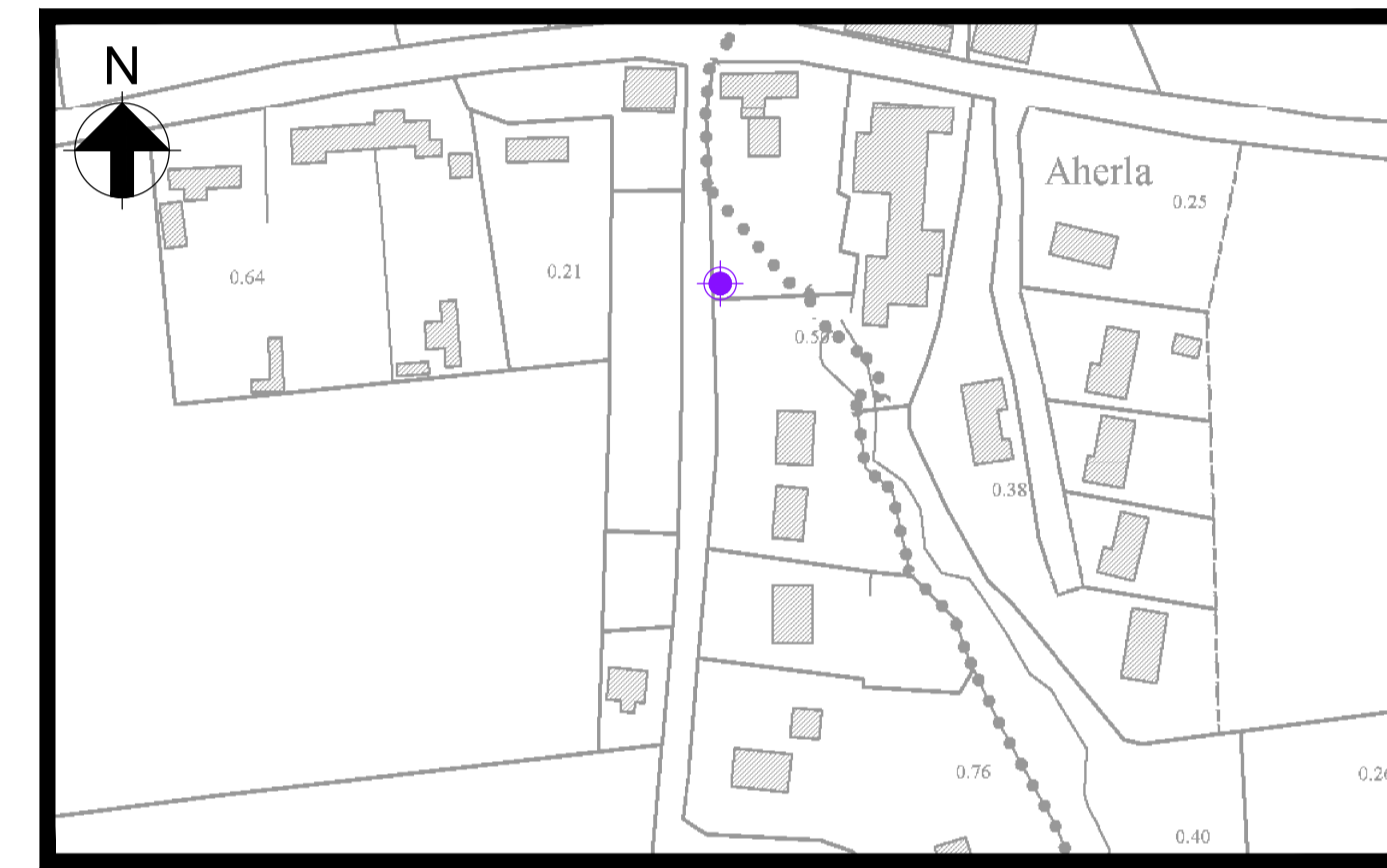

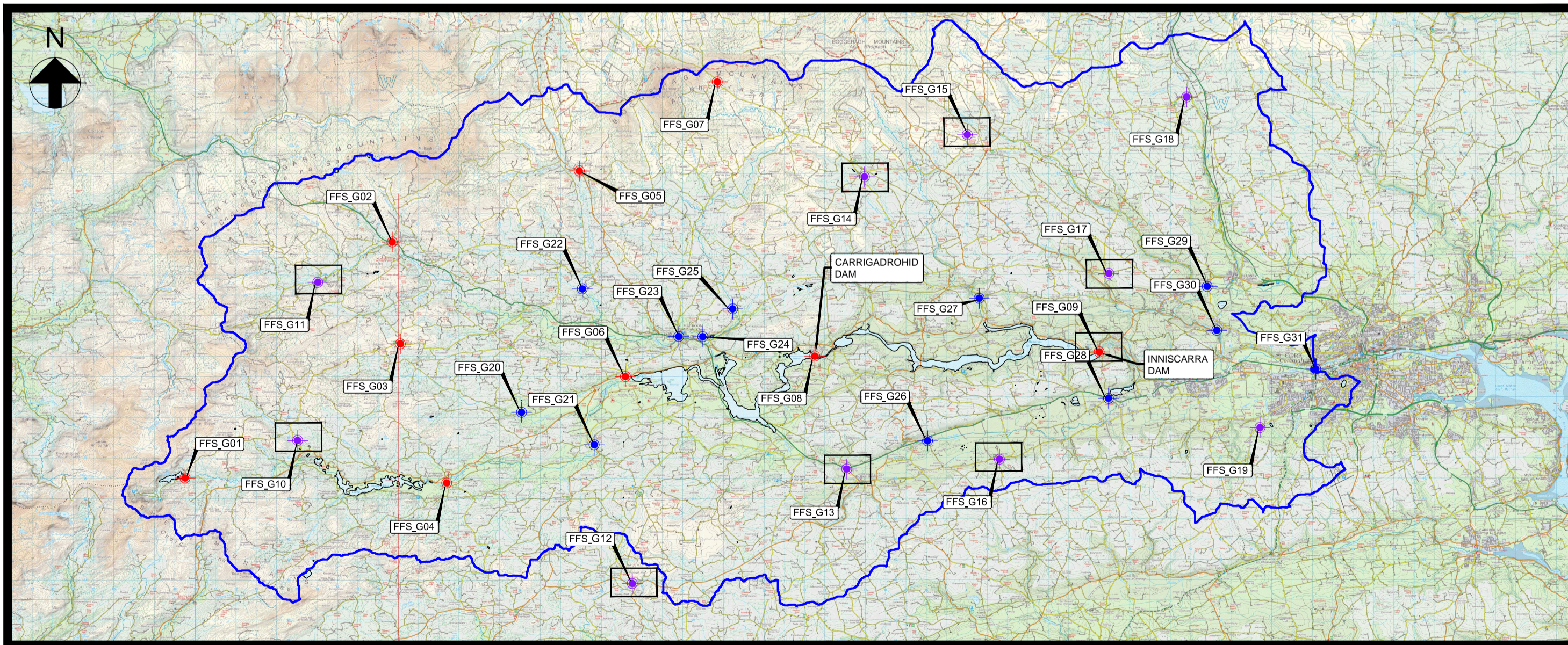

FFS\_G16 (Aherla Pumphouse) Scale 1:2000 at A1  
Scale 1:4000 at A3

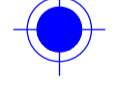

Location Plan Scale 1: 200 000 at A1  
Scale 1: 400 000 at A3

Key to Plan

-  Proposed Rain Gauges
-  Proposed River Gauges
-  Proposed Access Routes
-  Extent of River Lee Catchment to Cork City (vicinity of Victoria Cross)

- Notes:
- Do not scale from drawing.
  - Proposed works geometry and extents are subject to detailed design.
  - This drawing should be read in conjunction with all other Lower Lee (Cork City) Drainage Scheme Exhibition Drawings and Schedules.

Drg. No. LL\_513 Proposed Access Routes and Works Area (Sheet 13 of 15)

**ARUP**

One Aung & Partners Ireland Ltd.,  
One Albert Quay,  
Cork, Ireland.  
Tel +353 (0)21 4277670  
Fax +353 (0)21 4272345

**JBA**  
consulting

24 Grove Island,  
County Kerry,  
Ireland.  
Tel +353 (0) 61 345463  
Fax +353 (0) 61 280146



Cork City Council,  
City Hall, Anglesea Street,  
Cork, Ireland.  
Tel +353 (0) 21 4966222.  
Fax +353 (0) 21 4276321



Cork County Council Headquarters,  
County Hall, Carrigrohane Road,  
Cork, Ireland.  
Tel +00 353 (0) 21 4276891  
Fax +00 353 (0) 21 4276321



51 St. Stephen's Green,  
Dublin 2,  
Ireland.  
Tel +353 (0) 1 647 6000  
Fax +353 (0) 1 661 0747