

RIVER SHANNON

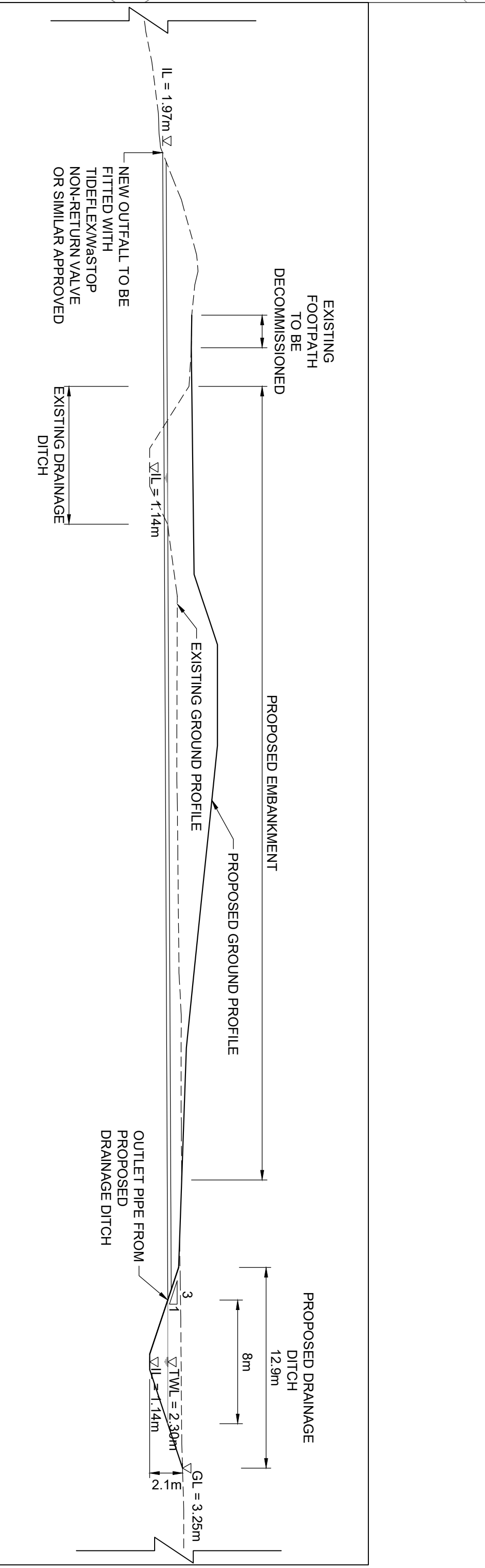
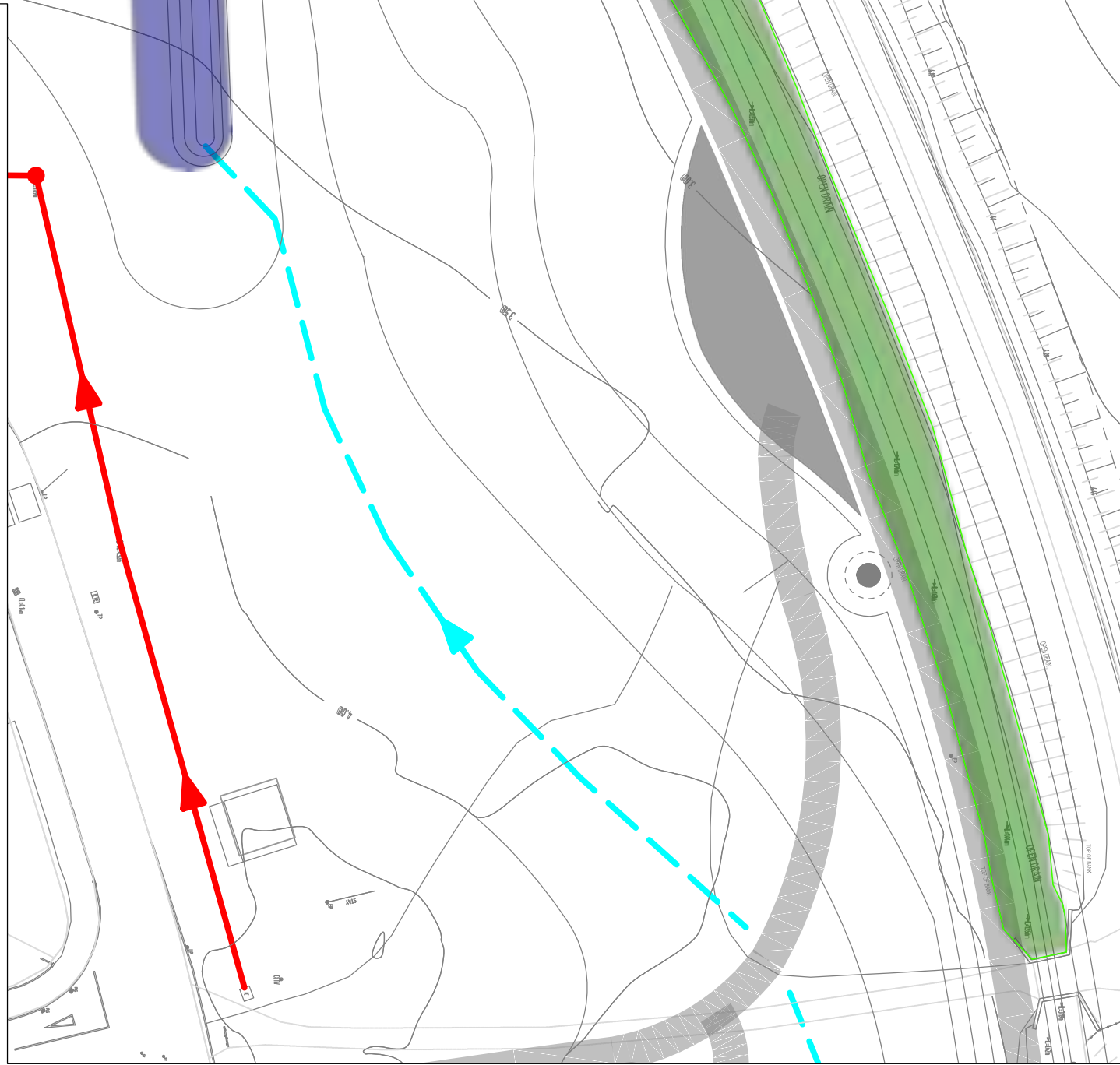
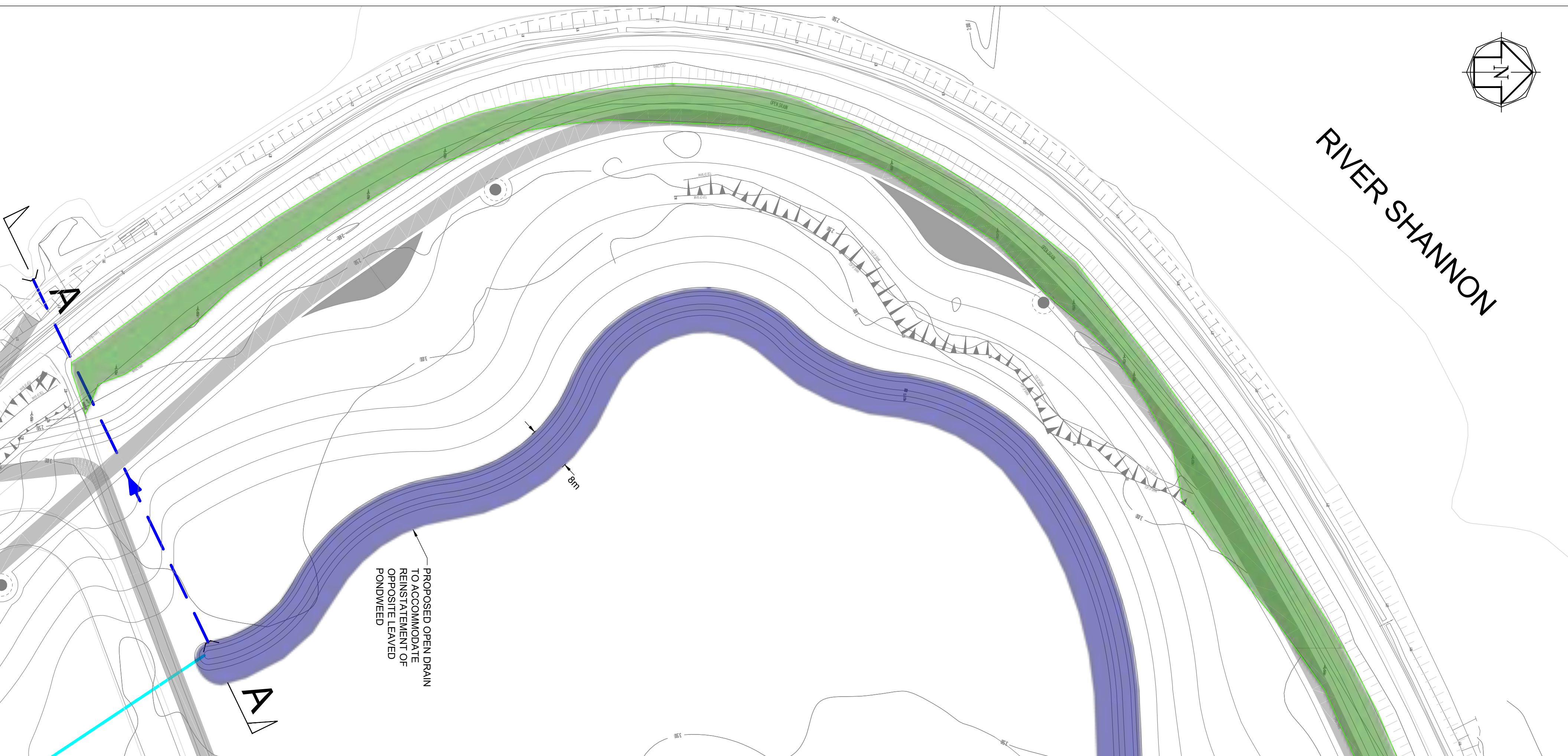

**LEGEND**

|  |   |
|--|---|
|  | EXISTING STORM SEWER  |
|  | EXISTING FOUL SEWER   |
|  | REDUNDANT SEWER   |
|  | PROPOSED STORM SEWER  |
|  | PROPOSED FOUL SEWER   |
|  | PROPOSED FILTER DRAIN   |
|  | PROPOSED SWALE  |
|  | EXISTING OPEN DRAIN   |
|  | PROPOSED OPEN DRAIN TO ACCOMMODATE REINSTATEMENT OF OPPOSITE LEAVED FOUNDED |

| Rev. | Description                   | Date     | Drawn | Checked | Approved |
|------|-------------------------------|----------|-------|---------|----------|
| D1   | PROPOSED POND PROFILE UPDATED | 28/03/19 | LL    | LL      | DW       |
| D0   | DRAFT FOR REVIEW              | 18/03/19 | LL    | DW      | DW       |

**JBA consulting**

24 Grove Island  
Cork City  
Co. Cork  
Ireland

www.jbaconsulting.ie  
t +353 353 0981 345463  
f +353 353 0981 280146  
e info@jbaconsulting.ie

for **LIMERICK CITY & COUNTY COUNCIL**  
**KINGS ISLAND FLOOD RELIEF SCHEME**  
**PROPOSED OPEN DRAIN**

This document is the property of JBA Consulting Engineers and Scientists Ltd. It shall not be reproduced in whole or in part, nor disclosed to a third party, without the permission of JBA Consulting Engineers and Scientists Ltd.

Scale: **1:500 @ A1**

Digital File Name: 201543218-012 D1.pdf

| Drawn | Checked | Approved | Date       |
|-------|---------|----------|------------|
| LL    | DW      | DW       | 19/03/2019 |
| DW    | DW      | DW       | 19/03/2019 |
| DW    | DW      | DW       | 19/03/2019 |

Drawing Number: 012 Rev.: D1 Sheet No.: 1 OF 1 Status: NPWS SUBMISSION

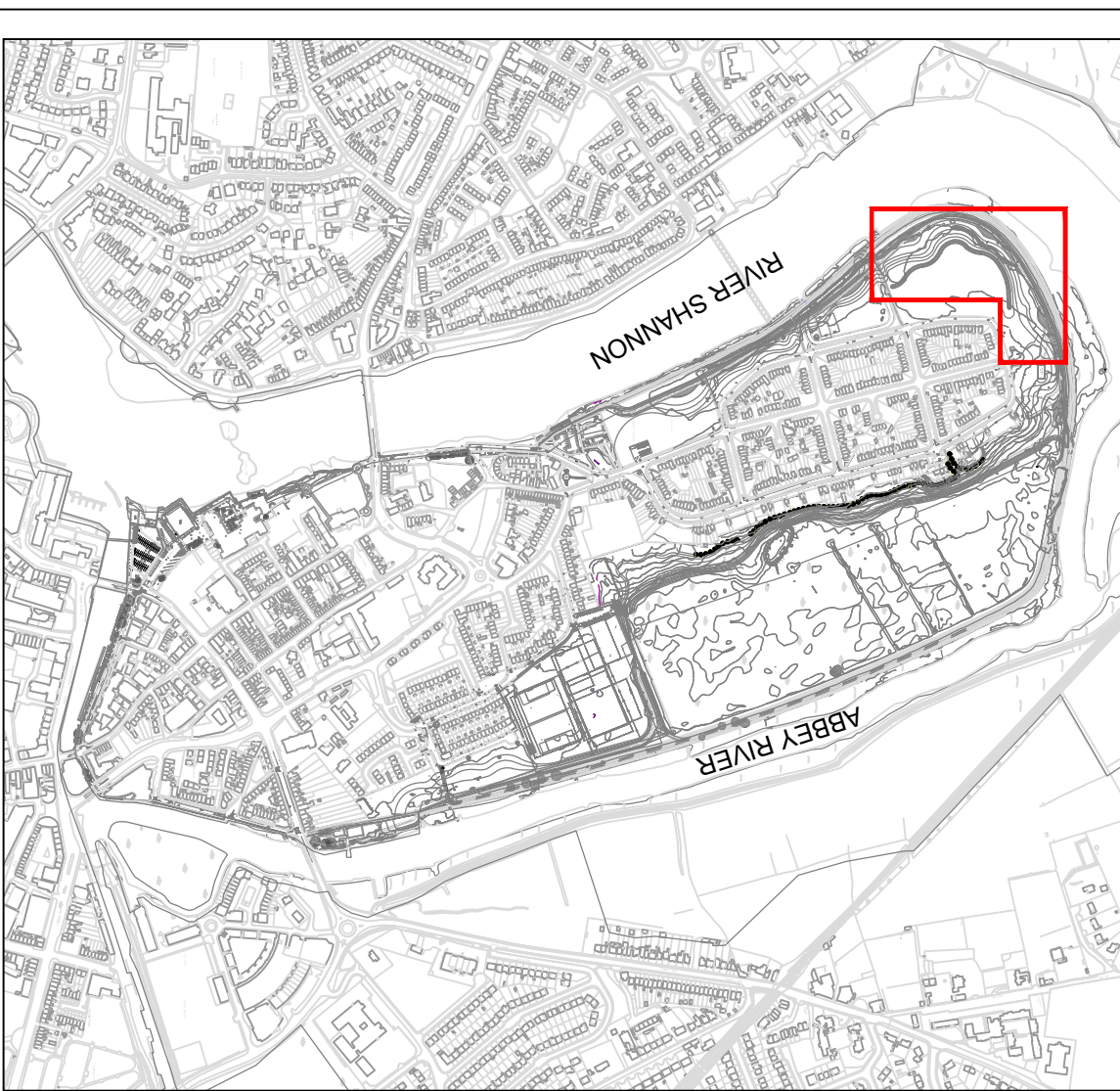

- General Notes**
- All dimensions shown are in metres unless otherwise stated and levels in metres to Ordnance Datum.
  - Do not scale from this drawing. All dimensions must be checked/verified on site.
  - Any discrepancies noted on site are to be reported to the Engineer immediately.
  - All works in watercourses will be carried out with care to minimise the risk of pollution adhering to Pollution Prevention Guidelines.
  - The locations of any known services shown on drawing are approximate and for guidance only. The Contractor will confirm the location of any services prior to the commencement of any works.
  - The electronic model of this drawing is not to be used for setting out.



WILDLIFE ACTS 1976 TO 2018 – SECTION 21

APPLICATION FOR A LICENCE TO TAKE ALTER OR OTHERWISE INTERFERE WITH THE HABITAT OR ENVIRONMENT OF A SPECIES OF PROTECTED FLORA FOR SCIENTIFIC, EDUCATIONAL OR OTHER PURPOSES

1. Name of applicant: Denyer Ecology on behalf of Kieran O’Gorman  
Limerick City and County Council
- Address: Limerick City and County Council, Merchants Quay, Limerick, V94 EH90
- [BLOCK LETTERS]
- Email Address: [joanne@denyerecology.com](mailto:joanne@denyerecology.com)  
[kieran.ogorman@limerick.ie](mailto:kieran.ogorman@limerick.ie)
- Telephone No.: 00353 86 2379153
2. Species: Opposite-leaved Pondweed *Groenlandia densa*
3. Location(s): See attached Methods Statement  
**(including maps where possible)**
4. Purpose for which alteration or interference with environment or habitat is proposed: Flood Relief Scheme, King’s Island, Limerick
5. Means by which specimens will be taken, altered or interfered with: (e.g. cutting, uprooting etc.) Existing ditch to be removed and new ditch will be created on same site. Licence application to remove plants from existing ditch and translocate to new ditch (see Methods Statement for more details).
6. Organisation to which applicant is affiliated: Denyer Ecology/ Limerick City and County Council
7. Period for which licence is required: 2020-22 (see Methods Statement for more details).



Signature: .....

Date: .....20 March 2019.....

**Where applicable include copies of survey work etc carried out on the species & site to which this application refers.**

**Please return completed  
application form to:**

Wildlife Licensing Unit (R. 2.03)  
National Parks & Wildlife Service  
90 North King Street  
Smithfield  
Dublin 7  
D07 N7CV



**An Roinn Cultúir,  
Oidhreacht agus Gaeltachta**  
Department of Culture,  
Heritage and the Gaeltacht

Tel.: (01) 888 3242

Email: [wildlifelicence@chg.gov.ie](mailto:wildlifelicence@chg.gov.ie)

**License application under the Wildlife Act 1976 to 2018**

**PRIVACY STATEMENT**

The Department of Culture, Heritage and the Gaeltacht is committed to protecting and respecting your privacy and employs appropriate technical and organisational measures to protect your information from unauthorised access. The Department will not process your personal data for any purpose other than that for which they were collected. Personal data may be exchanged with other Government Departments, local authorities, agencies under the aegis of the Department, or other public bodies, in certain circumstances where this is provided for by law. The Department will only retain your personal data for as long as it is necessary for the purposes for which they were collected and subsequently processed. When the business need to retain this information has expired, it will be examined with a view to destroying the personal data as soon as possible, and in line with Department policy. Further information on Data Protection can be found on our website at:

<https://www.chg.gov.ie/help/legal-notice/data-protection/>



An Roinn Cultúir,  
Oidhreacht agus Gaeltachta  
Department of Culture,  
Heritage and the Gaeltacht

Licence No. FL08/2019

**NATIONAL PARKS AND WILDLIFE SERVICE**

**Wildlife Acts 1976 to 2018- Section 21**

**LICENCE TO TAKE PROTECTED FLORA, ALTER OR OTHERWISE INTERFERE WITH THE HABITAT OR ENVIRONMENT OF A SPECIES OF PROTECTED FLORA**

The Minister for Culture, Heritage and the Gaeltacht in exercise of the powers conferred on her by Sections 9 and 21 of the Wildlife Acts 1976 to 2018 authorises:

**Denyer Ecology on behalf of Kieran O’Gorman, Limerick City and County Council,  
Merchants Quay, Limerick, V94 EH90**

To take, alter or otherwise interfere with the habitat or environment of a species of protected flora as specified in Column 1 of the Schedule hereunder, in the manner specified in Column 2, in the location specified in Column 3 for the purpose of implementation of a conservation management plan to mitigate impacts of proposed development and future sea level rises subject to the conditions listed below during the period beginning on the 1<sup>st</sup> day of January 2020 and ending on the 31<sup>st</sup> day of December 2023.

**SCHEDULE**

| 1                        | 2   | 3                       |
|--------------------------|---|-------------------------|
| Species                  | Manner of taking protected species and/or altering or otherwise interfering with its habitat or environment.  | Location                |
| <i>Groenlandia densa</i> | As described in “ <i>Section 21 Application. Groenlandia densa Methods Statement, March 2019.</i> Unpublished report to NPWS, in support of Section 21 Licence application prepared by Denyer Ecology” its two appendices A&B, the detailed translocation plan (to be finalised and agreed with NPWS and incorporated, with a revised and finalised <i>Methods Statement</i> , into a <i>Conservation Management Plan</i> ), as well as any subsequent modifications to these as may be proposed and agreed NPWS: <ul style="list-style-type: none"> <li>• Removal of plants, plant fragments and sediment;</li> <li>• Transfer of removed material to secure storage;</li> </ul> | King’s Island, Limerick |