

# R639 GLANMIRE RD - TREE FEELING WORKS - STOP & GO

DESIGN PARAMETERS	
CHAPTER 8 ROAD LEVEL:	1(III)
SPEED LIMIT:	50km/h
ROADWORKS TYPE:	B
NUMBER OF AWS:	2
SIGN VISIBILITY:	50m
DISTANCE BETWEEN SIGNS:	20m
SIGNS SIZE RECTANGULAR - MIN.:	600mm
SIGNS SIZE CIRCULAR - MIN.:	600mm
CONE HEIGHT - MIN.:	750mm
TAPER CONE SPACING:	3m
LONGITUDINAL CONE SPACING:	3m
RATE OF TAPER:	LANE - 45°; HS - N/Am
SAFETY ZONE:	LONGITUDINAL - 5m; LATERAL 0.5m
UNOBSTRUCTED WIDTH:	N/A
MAXIMUM LENGTH OF SHUTTLE:	200m
MINIMUM LANE WIDTH:	3m
TM SYSTEM:	STOP & GO

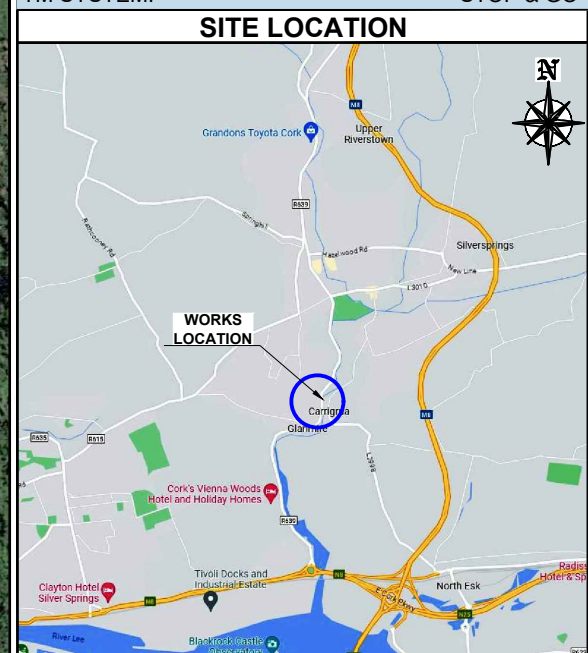

**SITE SPECIFIC NOTES**

a) Exact temporary sign location to be assessed and installed on site by TTOS  
 b) Footpath to be maintained and managed.  
 c) Local traffic to be maintained at all times.

**LEGEND**

- TEMPORARY TRAFFIC SIGN
- TRAFFIC CONES
- SAFETY ZONE
- SITE/COMPOUND AREA
- PEDESTRIAN ROUTE
- PEDESTRIAN BARRIERS

REV	DESCRIPTION	DATE	REV BY	CHK BY

CLIENT: **SORENSEN**

PROJECT: **GLASHABOY FLOOD RELIEF SCHEME  
GLANMIRE, CO.CORK**

TITLE: **R639 GLANMIRE RD  
TREE FEELING WORKS - STOP & GO**

DIRECTOR:	BE	PM:	AA	CHECKED:	AA
SCALE:	NTS	DRAWN BY:	EB	DATE:	18/09/23
STAGE:	CONSTRUCTION				A3 (297x420mm)
DRAWING NO.:	EN 6765 - 000 - 015				REV: 00

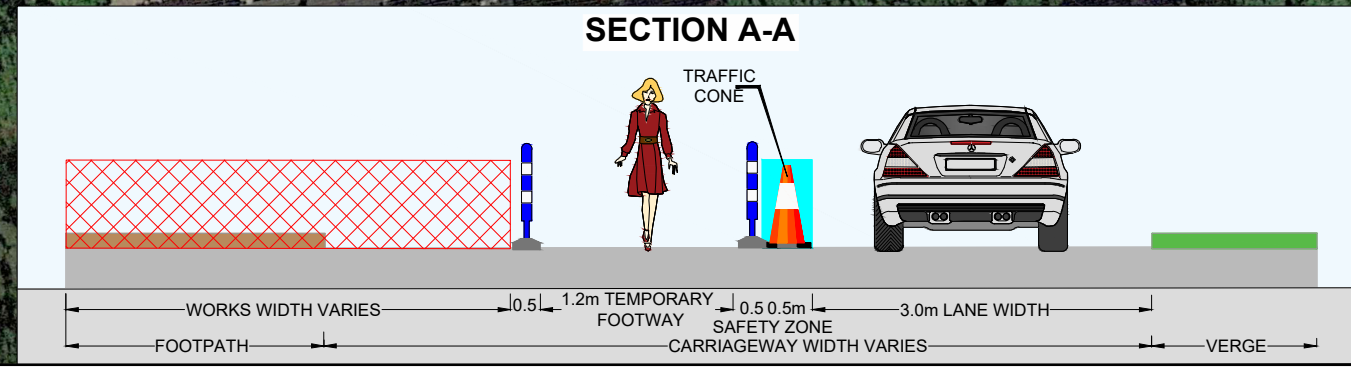
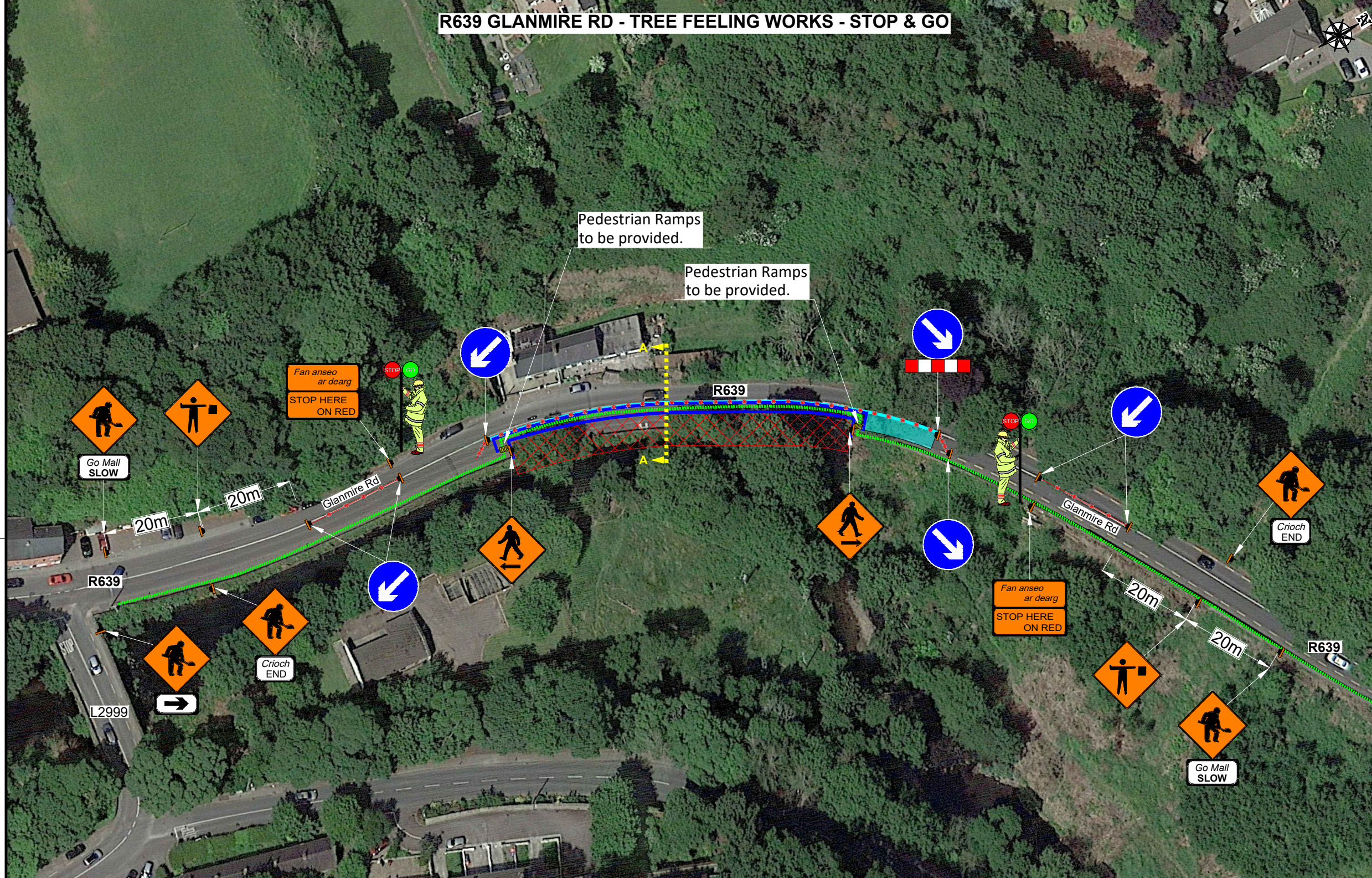

UNIT 28, SECOND AVE  
COOKSTOWN IND. EST.  
TALLAGHT, D24, IRELAND  
TEL: (01) 424 2070  
EMAIL: info@chmtd.ie  
WEB: www.chmtd.ie

UNIT 6, WATERGRASSHILL  
BUSINESS PARK,  
CO. CORK, T56 TD42  
TEL: +353868118317

**GENERAL NOTES**

- THIS TRAFFIC MANAGEMENT PLAN MAY ONLY BE IMPLEMENTED BY A TEMPORARY TRAFFIC OPERATIONS SUPERVISOR (TTOS) WHO MUST CARRY OUT A SITE RISK ASSESSMENT TO MODIFY (IF NECESSARY) THE MEASURES DESCRIBED TO SUIT ACTUAL SITE CONDITIONS BEFORE IMPLEMENTATION.
- THE TTOS MUST BE IN POSSESSION OF THE VALID CONSTRUCTION SKILLS REGISTRATION CARD SIGNING, LIGHTING, AND GUARDING AT ROADWORKS' CONSTRUCTION REGULATIONS, 2006 AND 2013-2021 CONSTRUCTION REGULATIONS.
- THE TTOS TO DETERMINE EXACT POSITION OF SIGNS CONSIDERING THE SITE SPECIFICS.
- IN ORDER THAT THE REQUIREMENTS SET OUT IN SECTION 17(2) OF THE SAFETY, HEALTH & WELFARE ACT (2005) AND SECTION 10 OF THE CONSTRUCTION REGULATIONS (2013-2021) ARE MET, THE PSCS MUST ADVISE THE PSDP AND ALL RELEVANT PARTIES OF ANY CHANGE TO THE TEMPORARY TRAFFIC MANAGEMENT PLAN.
- ALL WORKS ARE TO BE CARRIED OUT IN ACCORDANCE WITH LOCAL AUTHORITY REQUIREMENTS AND TO BE INCLUDED IN THE SITE SPECIFIC SAFETY & HEALTH PLAN.
- MAINTENANCE CHECKS SHOULD BE CARRIED OUT AT REGULAR INTERVALS AND IN ACCORDANCE WITH CONTRACT SPECIFICATIONS.
- TEMPORARY TRAFFIC OPERATIONS SUPERVISOR TO CARRY OUT A SITE RISK ASSESSMENT PRIOR TO THE INSTALLATION OF THE TRAFFIC MANAGEMENT PLAN TO ENSURE THAT CONDITIONS REFLECT THOSE CONSIDERED FOR DESIGN POST SUBMISSION.
- ALL SIGNS, USED FOR THIS TRAFFIC MANAGEMENT PLAN MUST COMPLY WITH CHAPTER 8 OF TRAFFIC SIGNS MANUAL LATEST EDITION.
- WK 052 THIS SIGN SHOULD BE USED TO INDICATE THE POSITION OF A SITE ENTRANCE AND/OR EXIT. REFER TO CH. 8 FOR USAGE.
- BANKS MEN TO MANAGE SITE ACCESS & EGRESS.
- IF SAFETY BARRIERS USED THIS MUST COMPLY WITH TII DN-REQ-03034-1 IS EN 1317-1 E) TEMPORARY SAFETY BARRIER THE APPROACH LENGTHS TO TERMINALS MUST BE KEPT CLEAR, AND NO WORKS SHOULD BE UNDERTAKEN IN THAT EXCLUSION ZONE AND SAFETY ZONE.
- THE CONTRACTOR SHALL BE RESPONSIBLE FOR PROVIDING ALL REQUIRED RAMP ACCESS TO ALL CHANGES IN ROAD SURFACE LEVEL WHERE TRAFFIC RUNS ON A TEMPORARY SURFACE AND ALSO FOR CYCLE/PEDESTRIAN RAMP WHERE THERE IS A LEVEL DISCONTINUITY AS A RESULT OF THE WORKS ON CYCLE PATHS & FOOTPATHS
- ADDITIONAL SIGNS MAY BE USED TO COMPLEMENT THE SPECIFIC SIGNS USED AT THE ROADWORKS: WARNING SIGNS - YELLOW BACKGROUND - DESCRIBED IN CHAPTER 6, REGULATORY SIGNS - DESCRIBED IN CHAPTER 5, ETC. THEY ALL MUST COMPLY WITH THE SPECIFICATIONS OF TRAFFIC SIGNS MANUAL AND T54 GUIDELINES. CERTIFICATION SCHEME AND SPECIFICATION FOR CONSTRUCTION OF TRAFFIC SIGNS.
- SET BACK TO BE MAINTAINED FROM TEMPORARY SIGN TO LIVE CARRIAGEWAY AS SET OUT ON CHAPTER 8 AND TTM OPERATIONS GUIDANCE
- ALL INFORMATION CONTAINED IN THIS DRAWING SHOULD BE CHECKED VERIFIED AND APPROVED PRIOR TO ANY STAGE OF CONSTRUCTION.