

Area 4
Emerging Preferred Option

Board
11



Constraints Map

- | | |
|---|---|
| 1. 3.0m high embankment above existing ground level | 9. Proposed open channel connecting drainage culvert to mill race upstream of mill race sluice gate. Bridge over channel required to maintain access, location to be agreed with land owner |
| 2. Sheet-pile to 8m depth to cut-off groundwater flow in the shallow gravel layer | 10. Upgrade existing mill race sluice gate. Maintain no or low flow through sluice gate to protect IDL site |
| 3. 3.1m high embankment above existing ground level | |
| 4. 3.0m high embankment above existing ground level | |
| 5. 2.8m high embankment above existing ground level | |
| 6. Culvert under proposed embankment to maintain drainage | |
| 7. 2.2m high embankment above existing ground level of Greenway | |
| 8. Non return valve fitted at drainage culvert outlet | |

The proposed defences are indicative only and may be subject to change during the planning/detailed design.

All proposed flood defences tie into high ground or existing/proposed defences at both extents.

Please refer to board No. 20 for potential flood defence finishes

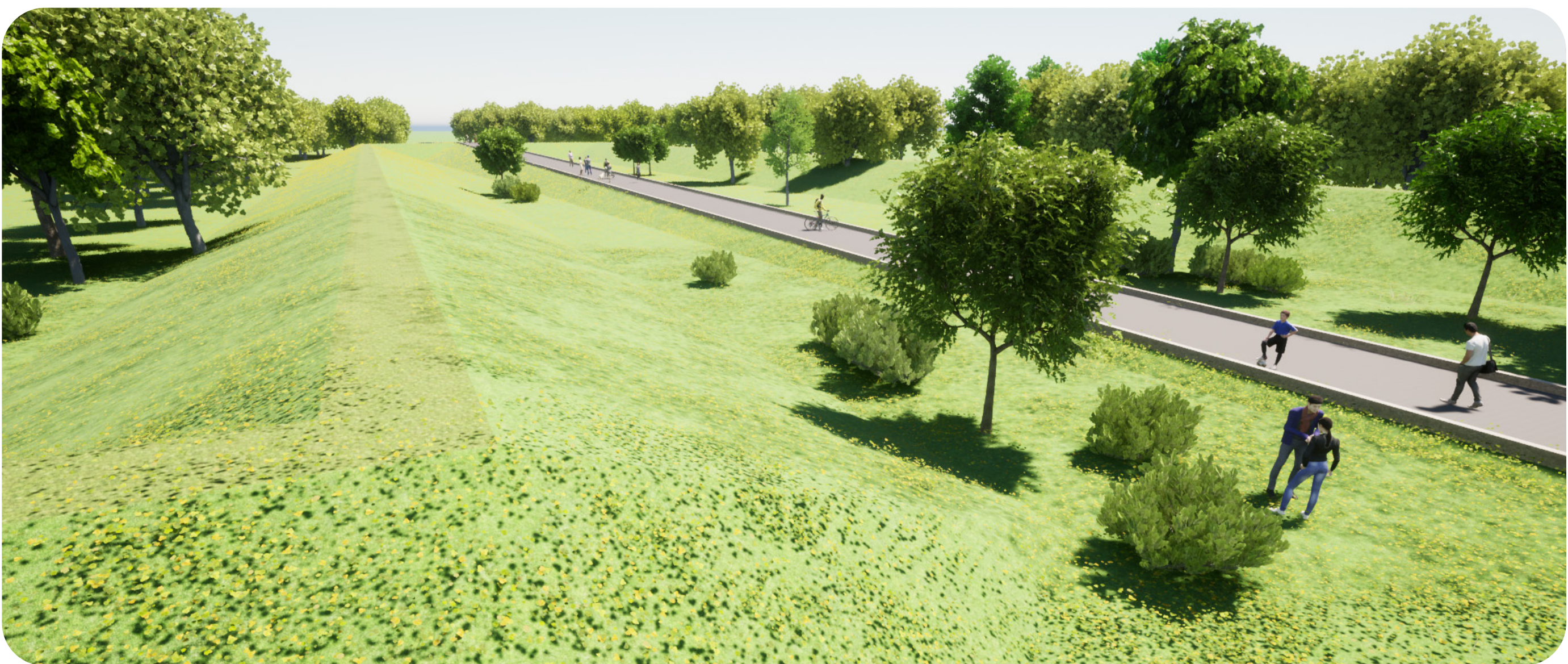

Your Feedback
is Important

This is your opportunity to have your views heard on the emerging preferred option

