

**Section CIE 6**  
(Lavitt's Quay West Drg. No. LL\_220)  
Scale 1:50 A1, 1:100 A3

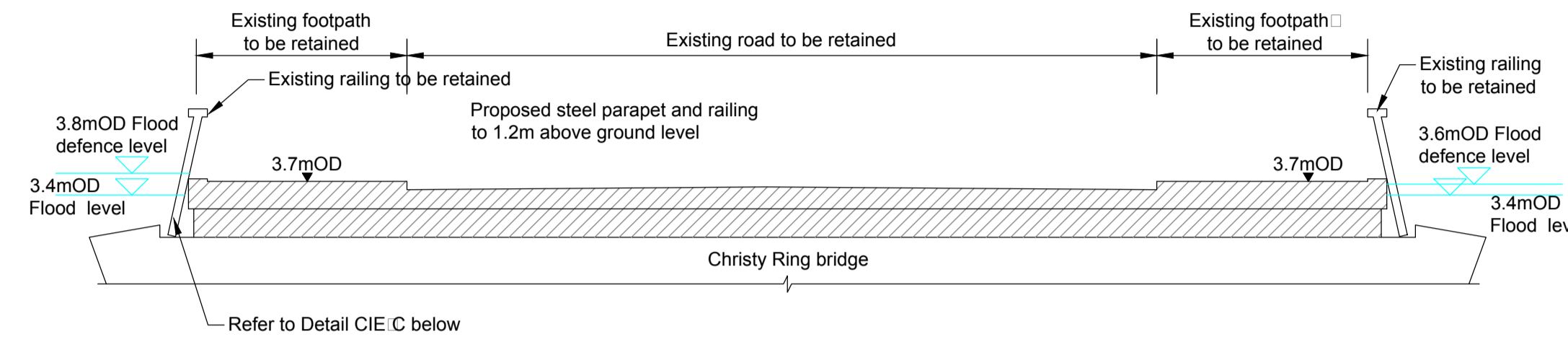

**Section CIE 7**  
(Christy Ring Bridge Drg. No. LL\_220)  
Scale 1:100 A1, 1:200 A3

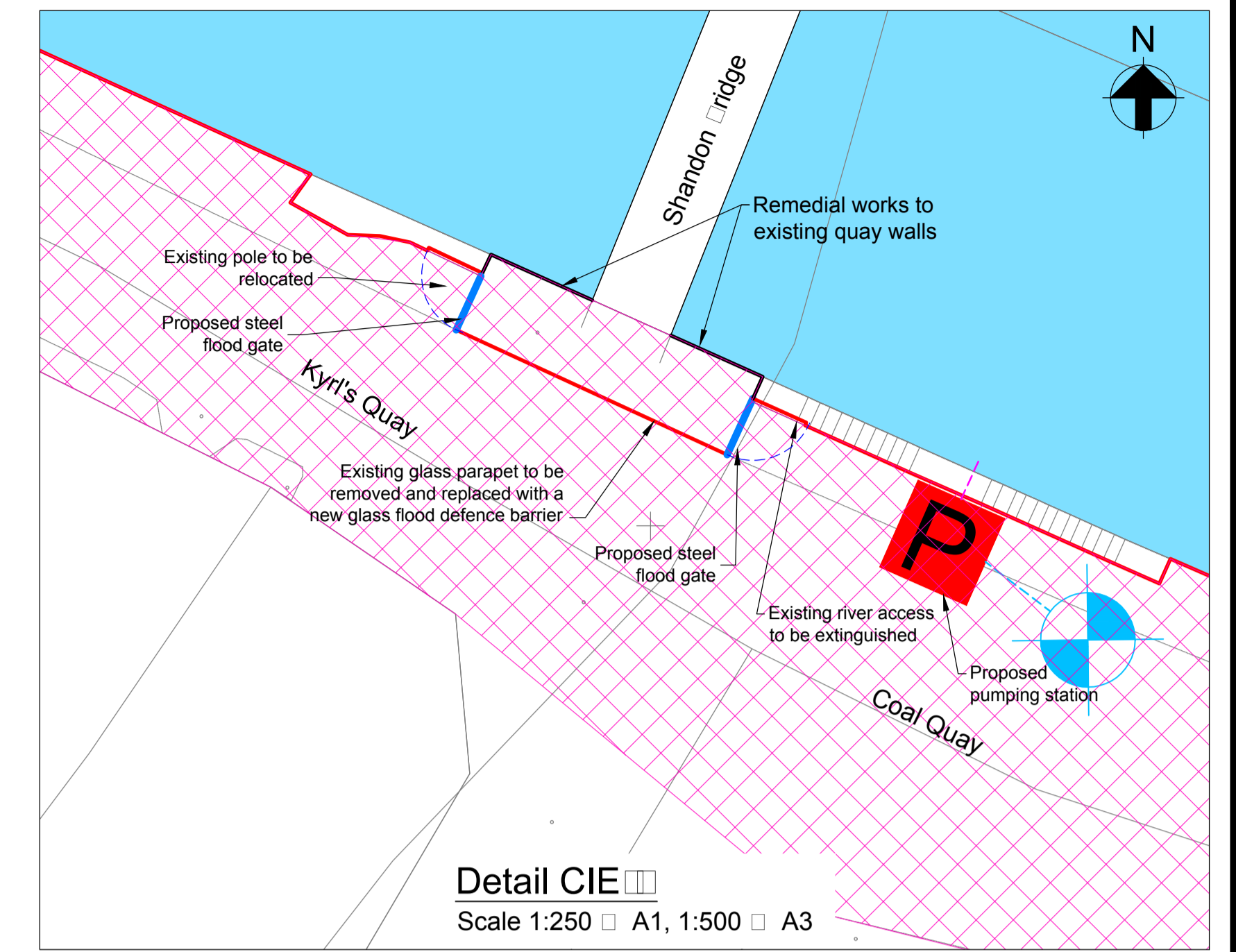

**Detail CIE B**  
Scale 1:250 A1, 1:500 A3

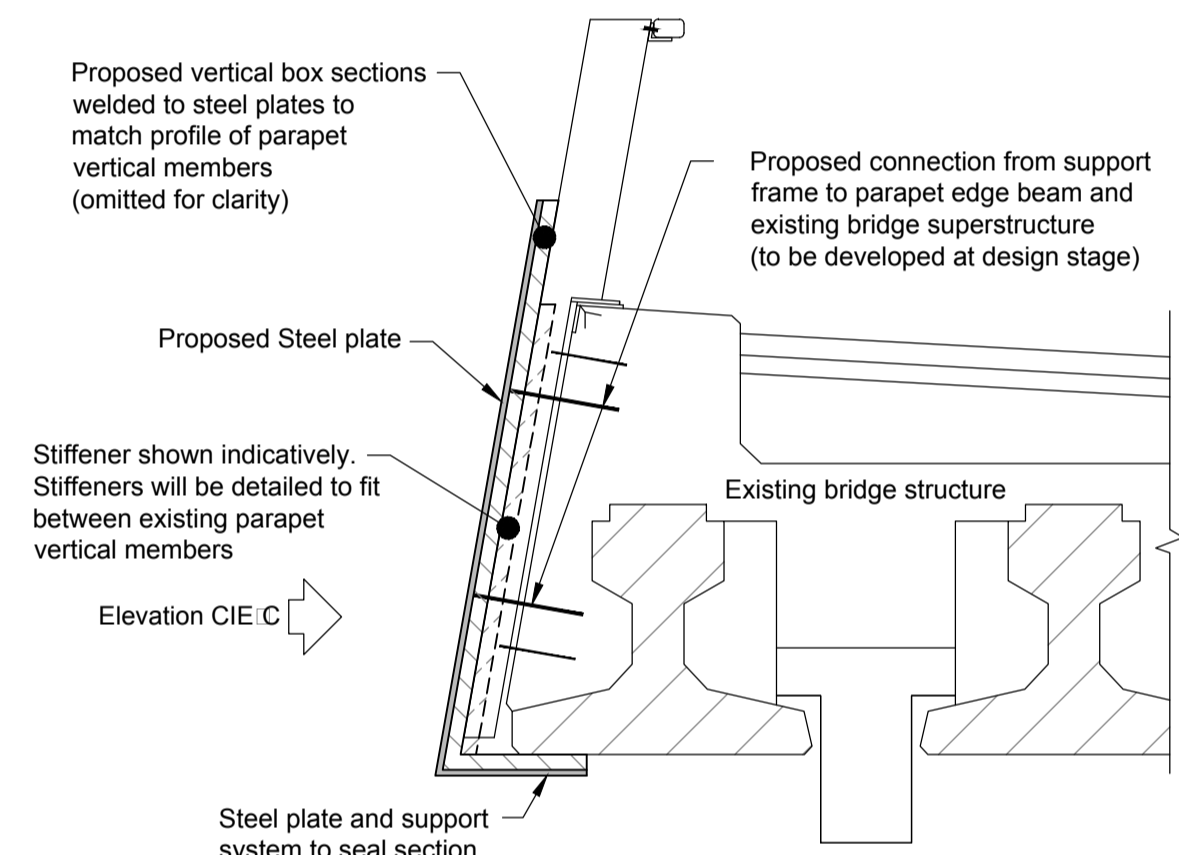

**Detail CIE C**  
Scale 1:25 A1, 1:50 A3

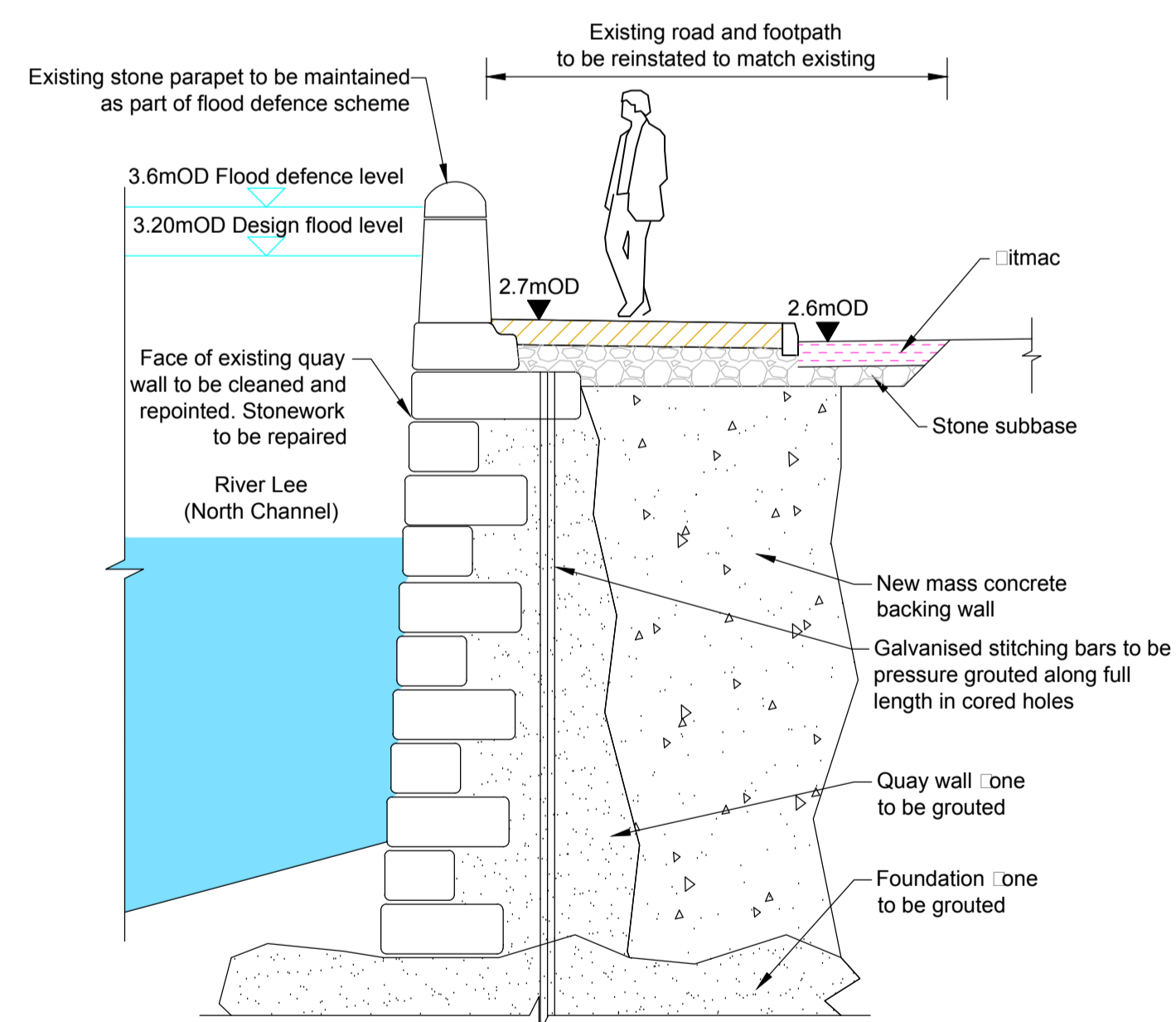

**Section CIE 8**  
(Lavitt's Quay East Drg. No. LL\_220)  
Scale 1:50 A1, 1:100 A3

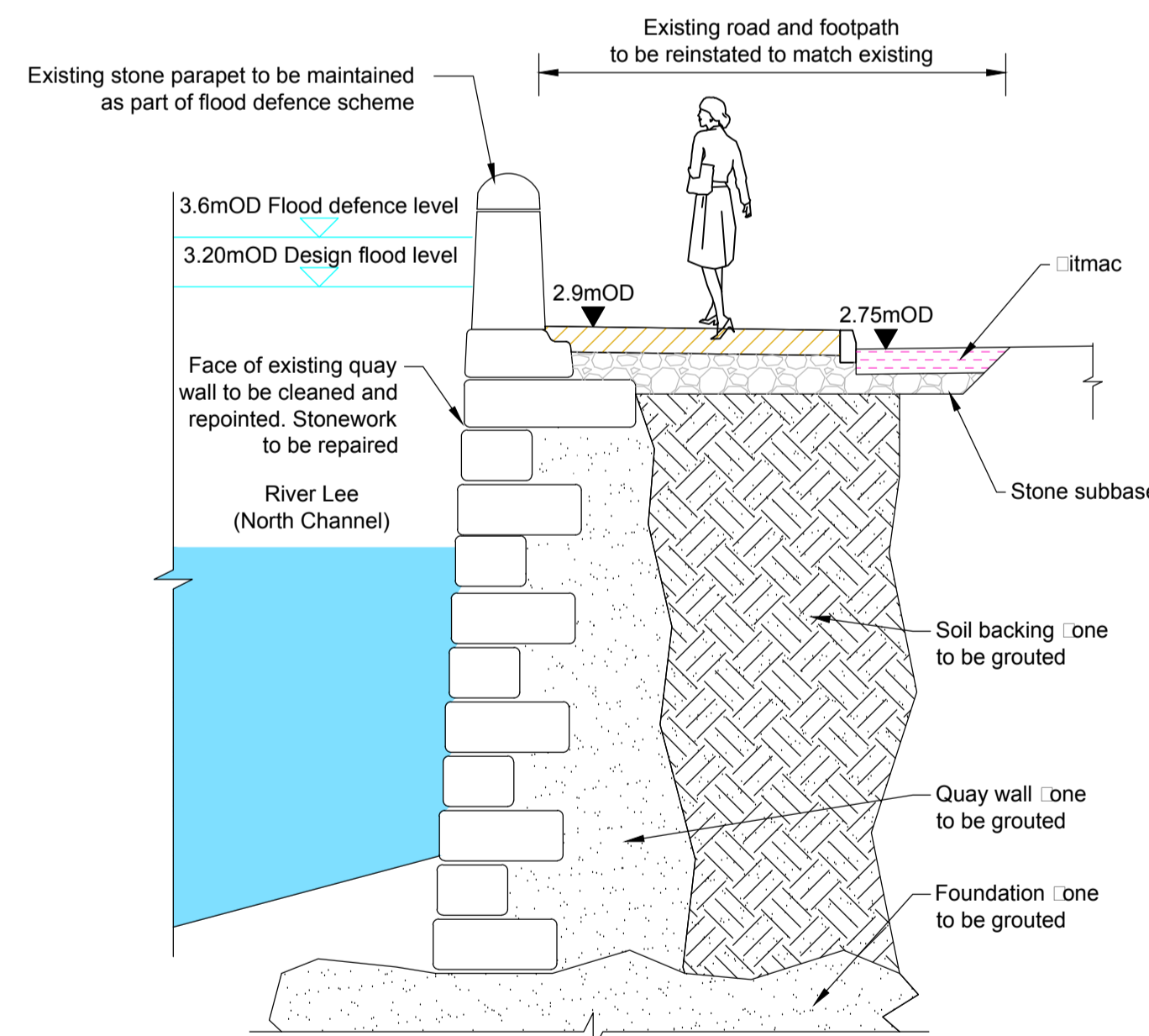

**Section CIE 9**  
(Lavitt's Quay East Drg. No. LL\_220)  
Scale 1:50 A1, 1:100 A3

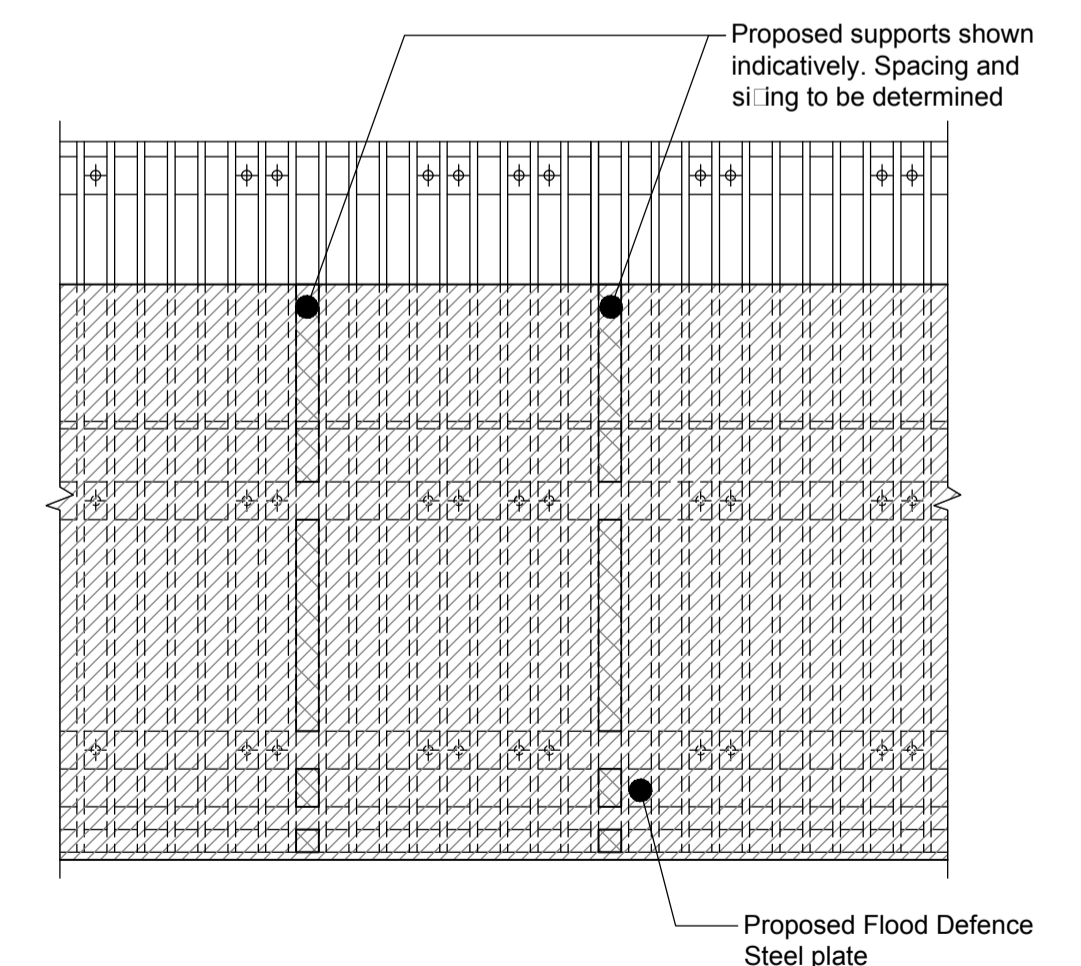

**Elevation CIE C**  
Scale 1:25 A1, 1:50 A3

**Notes:**

1. Do not scale from drawing.
2. Proposed works geometry and extents are subject to detailed design.
3. This drawing should be read in conjunction with all other Lower Lee (Cork City) Drainage Scheme Exhibition Drawings and Schedules.

 One Arup & Partners Ireland Ltd., One Albert Quay, Cork, Ireland. Tel: +353 (0)21 4277670 Fax: +353 (0)21 4272345	 24 Grove Island, Corbally, Co. Limerick, Ireland. Tel: +353 (0)61 345463 Fax: +353 (0)61 280146	 Cork City Council, City Hall, Anglesea Street, Cork, Ireland. Tel: +353 (0)21 4966222 Fax: +353 (0)21 4314238	 Cork County Council Headquarters, County Hall, Carrigrohane Road, Cork, Ireland. Tel: +00 353 (0)21 4276891 Fax: +00 353 (0)21 4276321	 51 St. Stephen's Green, Dublin 2, Ireland. Tel: +353 (0)1 647 6000 Fax: +353 (0)1 661 0747
---	--	---	---	--