

been a single narrow entrance into the harbour at King's Island a second, new entrance to a quay area was opened to the north (Figure 11).

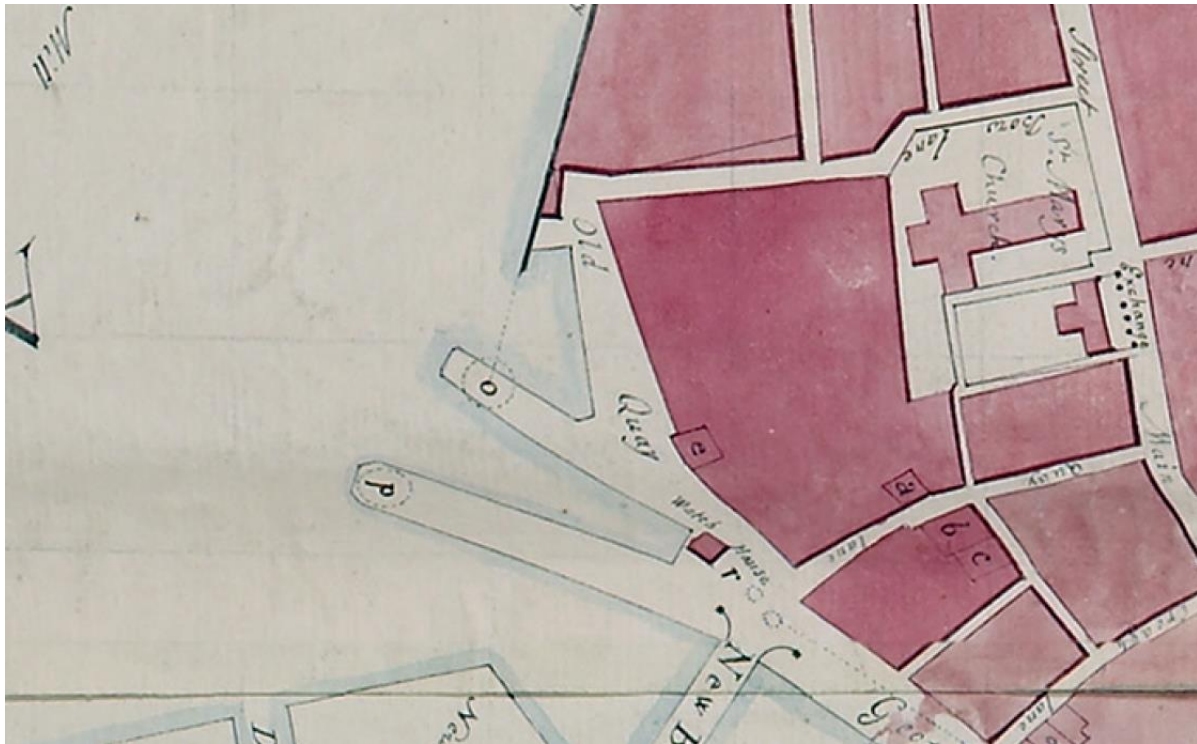

Figure 12. Extract from *Limerick, 1769* by Christopher Colles (British Library) (Irish Historic Towns Atlas No. 21 Limerick, Map 18) showing second entrance to a quay to the north.

This quay was later filled in and the Court House constructed in the area during the early 19th Century. It is evident from an overlay of modern surveys that a section of City Wall may still be extant in the area between the Court House and the Council's Offices (Figure 13).

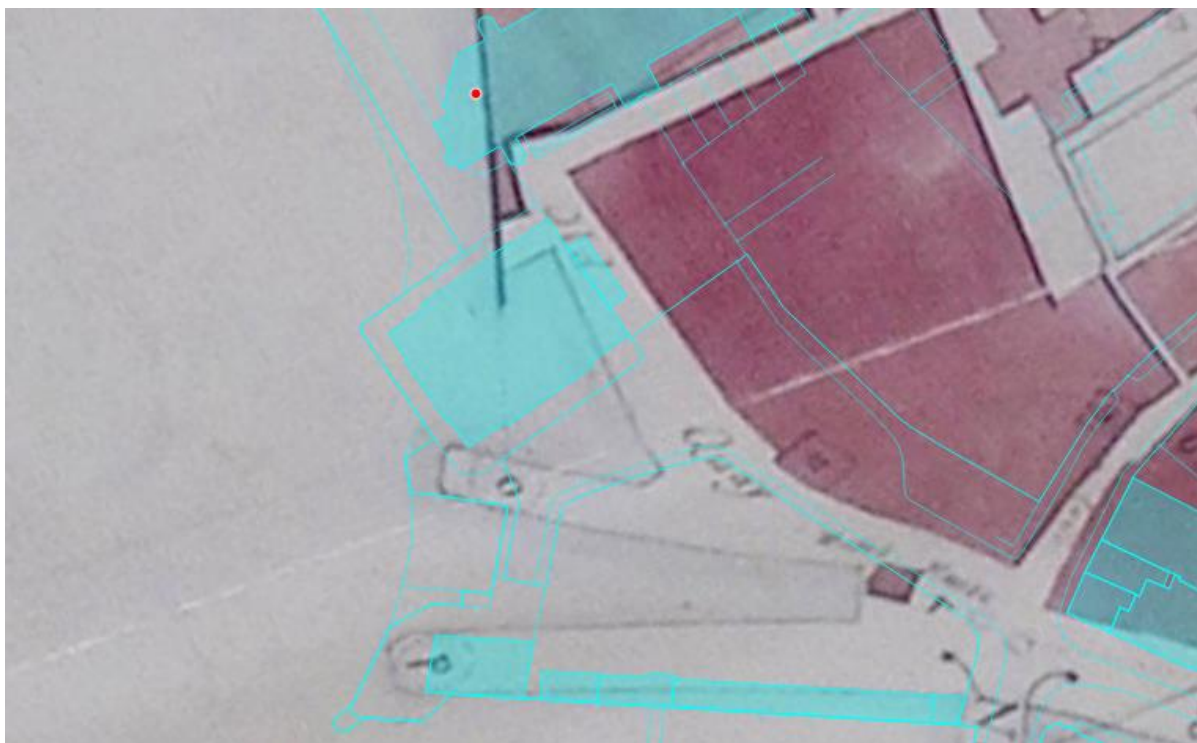

Figure 13. Extract from *Limerick, 1769* by Christopher Colles (British Library) (Irish Historic Towns Atlas No. 21 Limerick, Map 18) overlaid with recent OSI Survey.

Celie O’Rahilly did place a trench in this area during archaeological excavations associated with the construction of the new Council Offices, however it appears that the trench may have been slightly to the east of this location and may have missed the City Wall if it was still in situ.

Proposed Works

It is proposed to construct a new gravity sewer between the Council’s Offices and the Court House. The invert level of the sewer in this area is approximately 3 m and the ground level is approximately 4.2 m.

Proposed Testing

TT2-1

Approx. 1.5 m x 10 m, depth approx. 1.5 m

A single test trench is proposed in Area 2 along the alignment of the proposed gravity sewer (Figure 14). The purpose of the test trench is to identify if there are any extant remains of the City Wall in this area that may be affected by the proposed construction of the sewer.

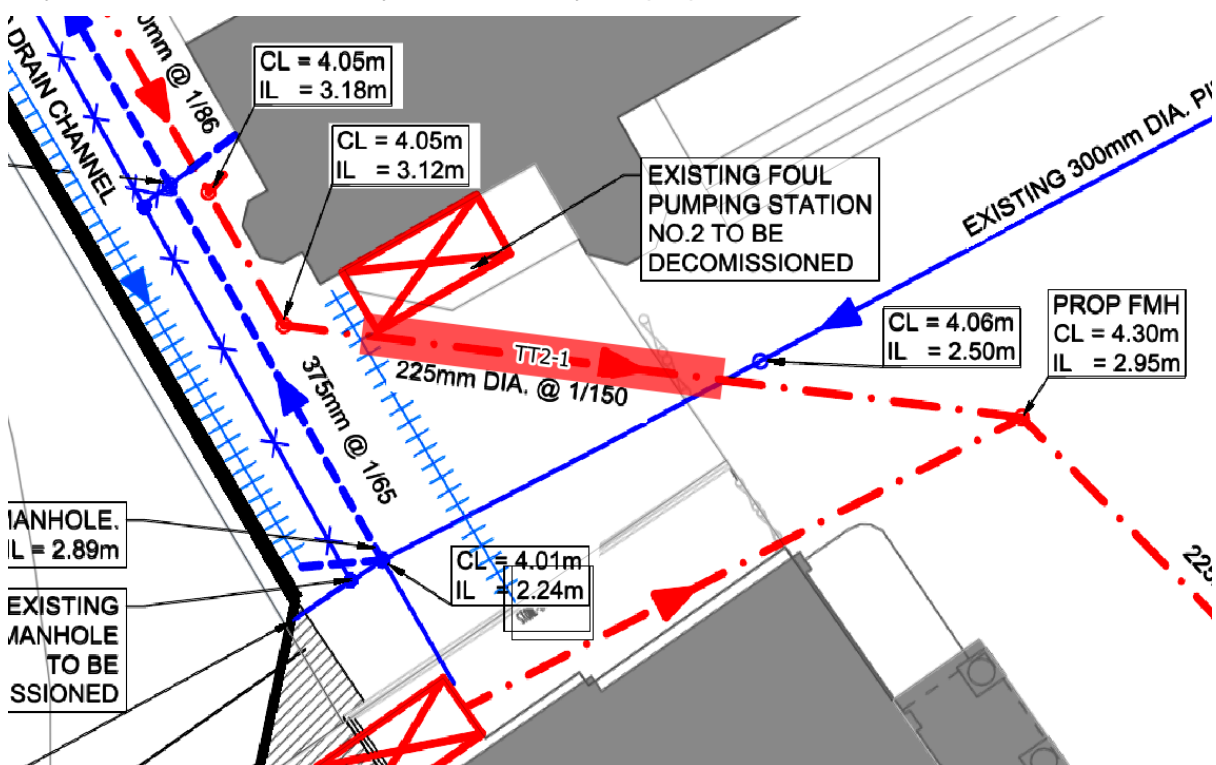

Figure 14. Proposed TT2-1 in Area 2.

Area 3

Archaeological Potential

Based on Colles’ map the central quay associated with the harbour during the late 18th Century was located in the vicinity of the southern corner of the Court House (Figure 13). It is possible that there is material that dates from the earlier entrance into harbour as is evident when OSI’s recent survey is overlaid on Phillips’ map of 1685.

Given the extensive work that took place in the area at the time when the new entrance to quay to the north was constructed, during the late 18th Century, and the work to construct the Court House itself, it is unlikely that there are any remnants of the City Wall still extant. However, given the protection afforded to the City Wall through the National Monuments Act and the recognition of the status of town walls in the National Policy on Town Defences (2008), it is important to confirm whether there are any remains present.



Figure 15. Extract from *Limerick, 1685* by Thomas Phillips (National Library of Ireland) (*Irish Historic Towns Atlas No. 21 Limerick, Map 12*) showing entrance to the harbour.

Proposed Works

Area 3 is situated to the south of the southern corner of the Court House. Flood defences are proposed along the coastal margins in the area. To support the flood defences, dig-out is to take place behind the quay walls to construct concrete foundations to a depth of approximately 4 m.

Proposed Testing

TT3-1 Approx. 1.5 m x 8 m, depth approx. 4m

TT3-2 Approx. 1.5 m x 6 m, depth approx. 4m

Two test trenches are proposed in Area 3, TT3-1 and TT3-2. Their extent is constrained by iron rail fencing around the Court House and a bench seat which is located parallel with the western face of the quay. The purpose of the test trenches (TT3-1 and TT3-2) is to ascertain whether there are any remains of the City Wall still extant.



Figure 16. Proposed test trench in Area 3 – TT3-1 and TT3-2.

Area 4

Archaeological potential

Early mapping, such as Colles' map from 1685, indicates that the southern range of the City Wall at the entrance into the harbour was located within the Potato Market (Figure 17). It would also appear that this area changed significantly towards the end of the 18th Century, with the construction of the new quays as indicated on Colles' Map (Figure 13).



Figure 17. Extract from *Limerick, 1685* by Thomas Phillips (National Library of Ireland) (*Irish Historic Towns Atlas No. 21 Limerick, Map 12*) with Area 4 indicated.

Proposed Works

A new flood defence wall is proposed between the Potato Market and the Boat Club to the west. To support the flood defences, dig-out is to take place to pour concrete foundations.

There is also a ramp to be constructed to allow access to the pedestrian bridge which extends south from the Potato Market, crossing the mouth of the Abbey River. The foundation for this ramp is to be relatively shallow (~0.5 m), however historic features associated with the previous quay and harbour walls would have been above high tide level and may, therefore, be located just below the surface. Proposed dig out for the flood wall between the Potato Market and the Boat Club is approximately 4 to 5 m depth.

Proposed Testing

TT4-1 to TT4-3

TT4-1 Approx. 1.5 m x 15 m depth approx. 4-5 m

The purpose of the test trench TT4-1 is to ascertain the nature and extent of any historic quay walls in the area of the proposed flood defence wall to the west of the Potato Market and to confirm whether or not there are any remnants of earlier quays in the area that may have been associated with the City Walls.

TT4-2 to TT4-3

TT4-2 Approx. 1.5 m x 20 m, depth approx. 0.75 m

TT4-3 Approx. 1.5 m x 6 m, depth approx. 0.75 m

The purpose of the test trenches TT4-2 and TT4-3 is to ascertain the nature and extent of any historic quay walls in the area of the proposed ramp and to confirm whether or not there are any remnants of earlier quays in the area that may have been associated with the City Walls.

TT4-4

TT4-4 Approx. 1.5 m x 10 m depth approx. 2 m

The purpose of the test trench TT4-4 is to ascertain the nature and extent of any historic quay walls in the area of the proposed surface water drainage and to confirm whether or not there are any remnants of earlier quays in the area that may have been associated with the City Walls.



Figure 18. Proposed test trenches in Area 4 – TT4-1 to TT4-4.

Area 5

Archaeological Potential

As has been noted in the discussion regarding Area 2, there were significant changes to the Merchant's Quay area in the late 18th Century, with the opening of a new entrance into a quay area in the vicinity of what is now the Court House.

Area 3, to the south of the Court House, is indicated as having been a quay area on Phillips' map of 1685 (Figure 19). Phillips' map is a good guide as it is spatially the most accurate of the 17th Century maps. However, even earlier maps, such as Hardiman's from 1590 (Figure 20), shows an extensive quays area to the east of the City Wall and north of the harbour entrance. It is interesting to note that Phillips indicates a second bounding wall further to the east that appears to enclose the quays area. This is likely a further layer of defence that may be part of the City's defences.



Figure 19. Extract from Limerick, 1685 by Thomas Phillips (National Library of Ireland) (Irish Historic Towns Atlas No. 21 Limerick, Map 12) with approx. location of Area 5 indicated.



Figure 20. Extract from Limerick c. 1590 by Hardiman (Trinity College Dublin) (Irish Historic Towns Atlas No. 21 Limerick, Map 6) show the quays area.



Figure 21. Extract from *Limerick, 1769* by Christopher Colles (British Library) (*Irish Historic Towns Atlas No. 21 Limerick, Map 18*) overlaid with recent OSI Survey, showing Area 5.

Proposed Works

In Area 5 it is proposed to construct an inter-tidal surface water storage tank. This will consist of a large underground surface water storage tank. Proposed depth of dig-out for the tank is approximately 3.5 m deep. There is an outfall from the storage tank to the south west which will include oil interception. The dig-out for the outfall will be to a similar depth as the inter-tidal storage tank. It is evident that the outlet for the outfall is located in a relative recent quay wall to the west that was constructed when the harbour was filled in the mid-19th Century.

Proposed Testing

TT5-1 to TT5-4

TT5-1 Approx. 1.5 m x 9 m, depth approx. 3.5 m

TT5-2 Approx. 1.5 m x 20 m, depth approx. 3.5 m

TT5-3 Approx. 1.5 m x 10 m, depth approx. 3.5 m

TT5-4 Approx. 1.5 m x 7 m, depth approx. 3.5 m

There are four test trenches associated with the inter-tidal storage tank proposed in Area 5. Their purpose is to identify the extent of quay walls and any other associated structure that may be present.

TT5-5

TT5-5 Approx. 1.5m x 10 m, depth approx. 3.5 m

The purpose of TT5-1 is to investigate the archaeological potential of the proposed outfall and oil interceptor.



Figure 22. Proposed test trenches in Area 5 – TT5-1 to TT5-5.

Area 6

Archaeological Potential

Area 6 is located in Merchant's Quay, to the west of Bridge Street. A review of early mapping indicates that this area has been associated with the harbour and quays since at least the 16th Century. It is clear from this early mapping that there was a gate to the east in this area that provided access to the quays from the east and that there was a substantial tower at the approximately location of the intersection of Bridge Street, Merchant's and George's Quay (Figure 23 and Figure 24). This tower was likely associated with manning the access to the quays but was also likely a defensive structure overlooking the Abbey River.

The tower was located at the bottom of Bridge Street, prior to the construction of Mathew Bridge, and historic maps indicate that Bridge Street turned to the east at its southern extent and continued as George's Quay. Based on this it appears likely that the towers and gate were located to the east of Bridge Street.



Figure 23. Extract from *Limerick c. 1590* by Hardiman (Trinity College Dublin) (*Irish Historic Towns Atlas No. 21 Limerick, Map 6*) showing the quays area, with gated entrance from the east evident.



Figure 24. Extract from *Limerick, 1685* by Thomas Phillips (National Library of Ireland) (*Irish Historic Towns Atlas No. 21 Limerick, Map 12*) with area 6 indicated.

Proposed Works

It is proposed that the gravity sewer will be constructed along an alignment from Merchant's Quay to Georges Quay (red dashed line in Figure 25). There are also regrading works proposed at the intersection, which will involve the removal of the road surface and a shallow

ground reduction (~0.5 m) of the shaded area indicated in Figure 25. New surface water drainage is also proposed, but this is to follow existing drains and no new excavation is envisaged to facilitate this.

It is noted that the gravity sewer increases in depth along its length and that at the point at which it crosses Bridge Street it will be required to be at a depth of approximately 2.5m and will amount to a substantial dig-out.

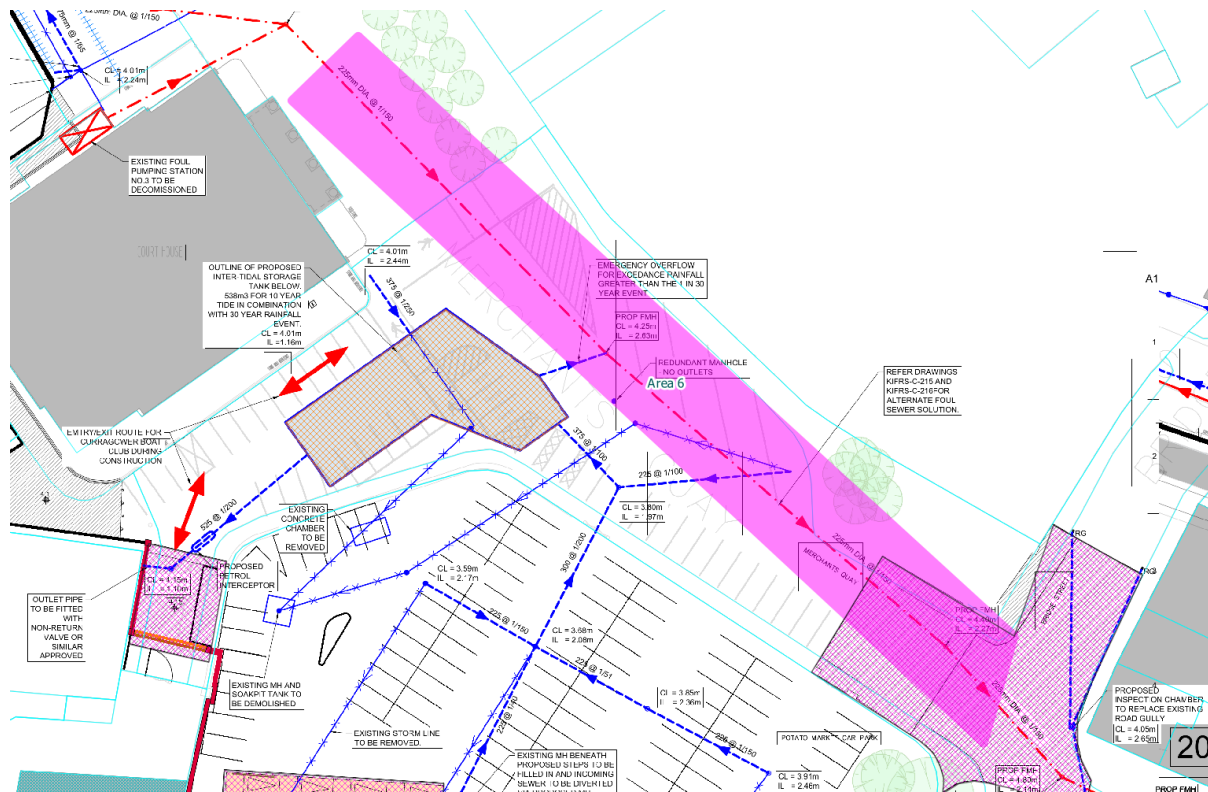

Figure 25. Proposed works at the intersection of Bridge Street, Merchant's Quay and George's Quay.

Proposed Testing

TT6-1 & TT6-4

TT6-1 1.5 m x 12 m, depth approx. 3 m

TT6-2 1.5 m x 6 m, depth approx. 3 m

TT6-3 1.5 m x 6 m, depth approx. 3 m

TT6-4 1.5 m x 6 m, depth approx. 3 m

There are four test trenches proposed in Area 6 (Figure 26), these are orientated roughly north south along the alignment of the proposed gravity sewer. The purpose of these test trenches is to try and ascertain whether there are any features associated with the City Wall located along the proposed route of the sewer and in the vicinity of Bridge Street.

The purpose of test trench TT6-1 is also to try and ascertain whether there are any remnants of the City Wall to the west of Bridge Street and, if so, whether there is a break in the wall at a sufficient depth to facilitate the proposed gravity sewer without impacting on the City Wall.

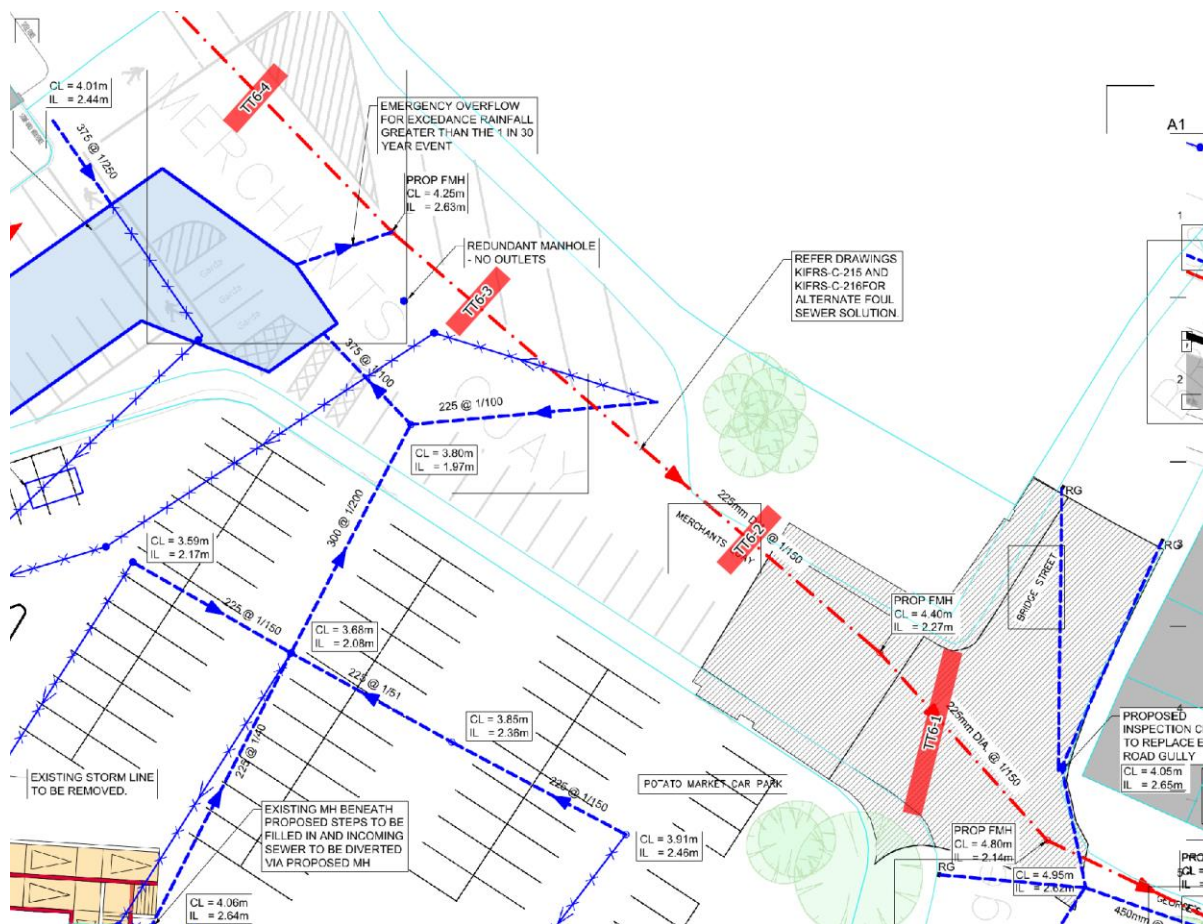

Figure 26. Proposed testing in Area 6 – TT6-1 & TT6-4.

Area 7

Archaeological Potential

Area 7 is located along George's Quay roadway immediately to the east of Bridge Street. Similarly to Area 6, this area is in the vicinity of the City Walls and tower and gateway associated with access into the quays area. However, as is noted in the archaeological potential discussion of Area 6, it is likely that the towers and gate were located to the west of Bridge Street.

Proposed Works

Similarly to Area 6 the main works in this area relate to the installation of the proposed gravity sewer, which given its distance from the Council's Offices is to be installed at over 2 m depth and will include substantial ground disturbance.

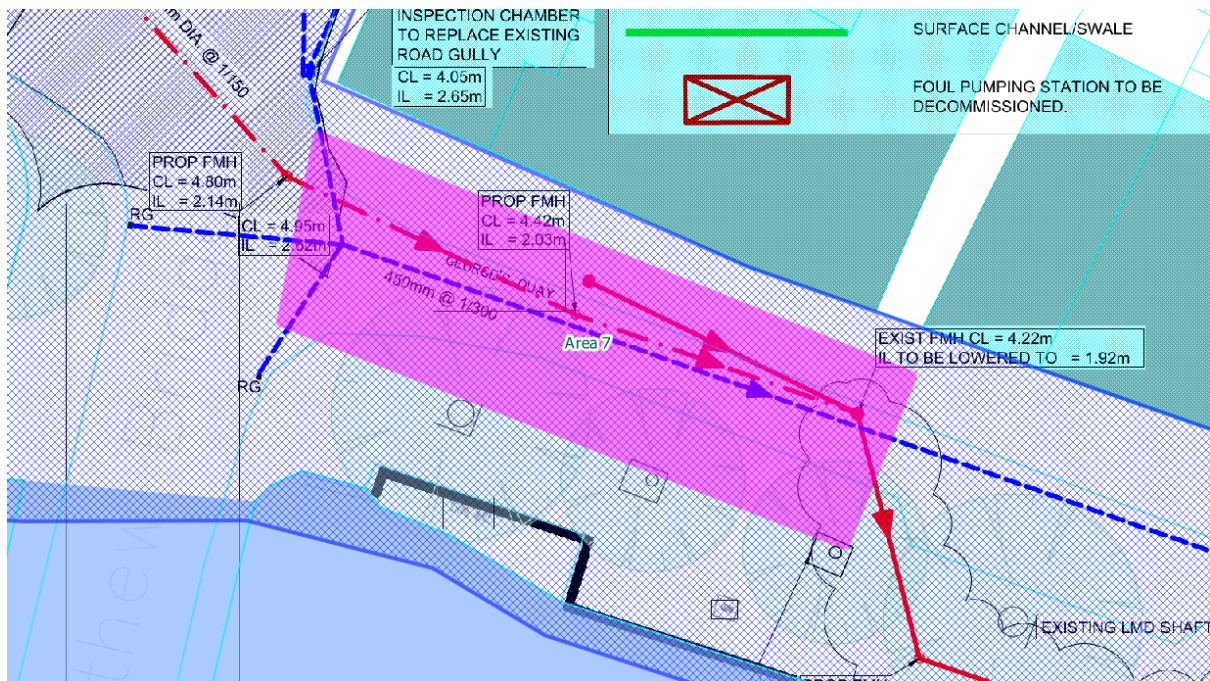

Figure 27. Proposed works at the western end of George's Quay with Area 7 indicated.

Proposed Testing

TT7-1 & TT7-2

TT7-1 1.5 m x 6 m, depth approx. 3m

TT7-2 1.5 m x 6 m, depth approx. 3m

There are two test trenches proposed in Area 7 (Figure 28), these are orientated roughly north south along the alignment of the proposed gravity sewer. The purpose of these test trenches is to try and ascertain whether there are any features associated with the City Wall located along the proposed route of the sewer and in the vicinity of Bridge Street.



Figure 28. Proposed testing in Area 7 – TT7-1 and TT7-2.

Appendix 1

A3 Figures

