

- NOTES:**
1. ALL WORKS ARE TO BE CARRIED OUT IN ACCORDANCE WITH ALL RELEVANT AUTHORITIES & CONTRACT REQUIREMENTS.
 2. CONTRACTOR LIAISONS ARE TO BE CARRIED OUT PRIOR TO WORKS & ALL ACCESS REQUIRING ACCESS ARE TO BE MAINTAINED & MANAGED AS AGREED WITH PROPERTY HOLDER.
 3. TM IS TO BE INSTALLED BY QUALIFIED OPERATIVES & ALL PERTINENT FACTORS RISK ASSESSED PRIOR TO INSTALLATION.
 4. EXACT SIGNS POSITIONS ARE TO BE AGREED ON SITE AND POSITIONED SO AS NOT TO HINDER PASSAGE OR VISIBILITY (Min Lateral & Height requirements to be met).
 5. WHERE A PREMISES IS OBSCURED A SIGN AS PER THE CONTRACT SPEC IS TO BE DISPLAYED .
 6. ACCESS TO ALL PROPERTIES, WHERE NECESSARY IS TO BE MAINTAINED - Additional TMO's may be required to manage access.
 7. EXISTING STATUTORY SIGNS SHOULD BE PROTECTED IF THEY DO NOT CONFLICT WITH PROPOSED SIGNAGE, OTHERWISE STATUTORY SIGNS SHOULD BE COVERED OR TEMPORARILY RELOCATED
 8. TEMPORARY TRAFFIC SIGNALS, TEMPORARY TRAFFIC SIGNAGE, TRAFFIC DELINEATORS AND ROAD MARKING ARE TO BE IN ACCORDANCE WITH TRAFFIC SIGNS MANUAL (DOT, NOV 2010)
 9. SIGN SIZE TO BE PER DOT CHAPTER 8 TABLE 8.3.2.1 & ALL SIGNS ARE TO BE REFLECTIVE - To be installed so not to block access (Vehicle or pedestrian) or visibility splays.
 10. WHERE NECESSARY THE PUBLIC SHOULD BE ADVANCE WARNED OF UPCOMING TRAFFIC MANAGEMENT THAT MAY CAUSE DELAY OR INCONVENIENCE.
 11. TM/PLANT & MACHINERY ARE NOT TO BE PLACED SO NOT TO HINDER VISIBILITY SPLAYS TO THE PASSING PUBLIC.
 12. ALL TRAFFIC CONES SHALL CONFORM TO BS EN 13422:2004 AND HAVE A REFLECTIVE SLEEVE, MINIMUM HEIGHT OF CONE TO BE 750mm.
 13. ROAD DANGER LAMPS WITH AMBER LIGHT (BS3143) AT 6m SPACINGS TO BE PLACED.
 14. END OF ROADWORKS TO BE PLACED 20-50m BEYOND TM. ADVANCE WARN SIGNAGE TO BE PLACED Xm IN ADVANCE OF TM OR JUNCTION STOP LINE.
 15. EXISTING PERMANENT SPEED LIMIT 50km/hr - LEVEL 1(iii)

PUBLIC REALM WORKS - Site Extension
ALL STOP for Peak Flow Pedestrian management

Pedestrian Management:
 1. Daytime Peak School Flow Manual TMO on 3-way All Stop
 2. Daytime Off Peak & Night either flashing amber Lights or uncontrolled if visibility to crossing points are maintained & light is sufficient.

Pedestrian Management:
 1. Daytime Peak School Flow Manual TMO on 3-way All Stop
 2. Daytime Off Peak & Night either flashing amber Lights or uncontrolled if visibility to crossing points are maintained & light is sufficient.

(Night-Time)

PEDESTRIAN MANAGEMENT
 A Pedestrian Path of suitable Gradient is to be provided within the working space (at any location):

- delineated by Site Fence
- pedestrian ramps where level difference occurs
- Signs Wk080 & Wk081 placed to direct pedestrians
- Footpath Closure Signs to be removed.

- LEGEND**
- WORKING SPACE
 - LONGITUDINAL SAFETY ZONE (Min 5m)
 - SITE / PEDESTRIAN FENCE - Per Contract Specifications.
 - TRAFFIC CONES (LENGTH / SPACING) OR SAFETY BARRIER- (Where Pedestrian diverted to carriageway & deep excavations)
 - EXISTING PEDESTRIAN PATH (Min 1.2m Width maintained)
 - DIVERTED PEDESTRIAN PATH
 - ACCESS ONLY PEDESTRIAN PATH
 - SIGN SYMBOL
 - LOCAL ACCESS ZONE
 - DIVERSION ROUTE
 - EXISTING ROAD MARKING
 - ROAD MARKINGS TO BE REMOVED / COVERED
 - TEMPORARY ROAD MARKING
 - SWEPT PATH ANALYSIS - REFUSE VEHICLE

SINGLE CARRIAGEWAY Level 1(iii) Type A	
DESIGN PARAMETERS	50km/hr
Sign Size (mm)	600
Sign Visibility (m)	50
No. of Adv. Signs	2
Cumulative Sign Distance (m)	40
Distance between Signs (m)	20
Taper Rate	1 in 5
Cone Height (mm)	750
Taper Cone Spacing (m)	3
45° Taper Cone Spacing (m)	1
Longitudinal Cone Spacing (m)	3
Lamp Taper Spacing (m)	6
Lamp Longitudinal Spacing (m)	6
Lateral Safety Zone (m)	0.5
Longitudinal Safety Zone (m)	5
Min Lane Width (m)	3.0
Optimum Lane Width (m)	3.3
Two-way Road Width (m)	6.0 Min

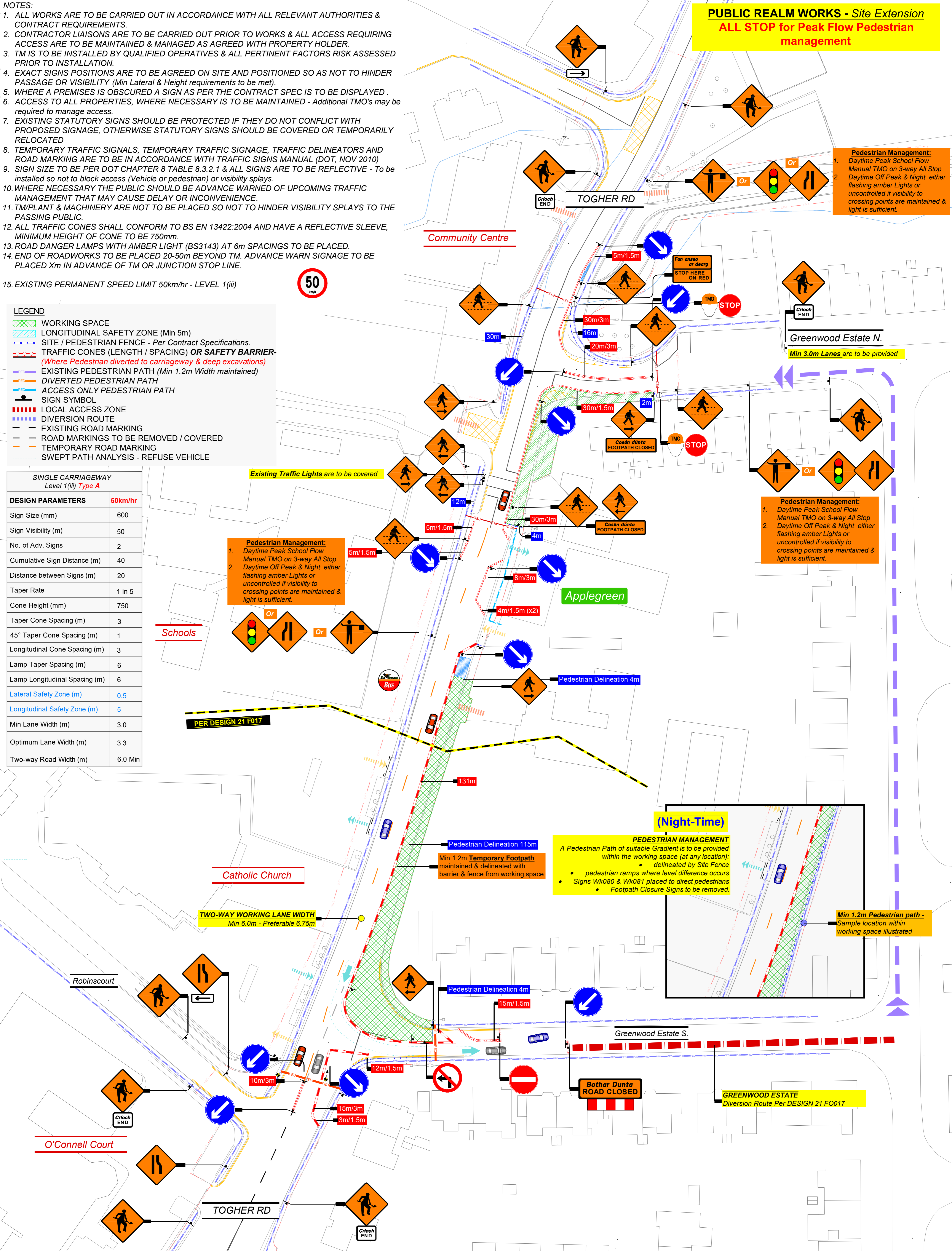

<table border="1"> <tr> <td>RS</td> <td>Design Issue for COMMENT or APPROVAL</td> <td>19/01/22</td> <td></td> <td></td> <td></td> </tr> <tr> <td>Stat</td> <td>Purpose of Issue</td> <td></td> <td></td> <td></td> <td></td> </tr> </table>		RS	Design Issue for COMMENT or APPROVAL	19/01/22				Stat	Purpose of Issue					<table border="1"> <tr> <td>EQUIPMENT REQ'D</td> <td>QTY</td> </tr> <tr> <td>SIGNS</td> <td>0</td> </tr> <tr> <td>CONES</td> <td>0</td> </tr> <tr> <td>PED TAPE</td> <td>0m</td> </tr> <tr> <td>SITE FENCE</td> <td>0m</td> </tr> <tr> <td>LAMPS (if Req'd)</td> <td>0</td> </tr> <tr> <td>MASSGUARD</td> <td>0m</td> </tr> <tr> <td>DELTA BLOC</td> <td>0m</td> </tr> </table>	EQUIPMENT REQ'D	QTY	SIGNS	0	CONES	0	PED TAPE	0m	SITE FENCE	0m	LAMPS (if Req'd)	0	MASSGUARD	0m	DELTA BLOC	0m	<p>McGinty O'Shea Traffic Management Design Ltd, Unit 13, Newcourt Shopping Centre, Church Street, Cavan Town, Co. Cavan, Ireland. Tel: +353 (0) 49 4327588 Mob: +353 (0) 86 0442650 Web: www.trafficmanagementdesignltd.com E-mail: roisino@tmdesign.ie</p>	<table border="1"> <tr> <td>Designed:</td> <td>ROR</td> </tr> <tr> <td>Drawn:</td> <td>ROR</td> </tr> <tr> <td>Checked:</td> <td>AMC / CMQ</td> </tr> <tr> <td>Approved:</td> <td>AV</td> </tr> <tr> <td>CAD File:</td> <td>21 FO018 REV1</td> </tr> <tr> <td>Scale:</td> <td>1:800 @A3</td> </tr> <tr> <td>Date:</td> <td>19/01/2022</td> </tr> </table>	Designed:	ROR	Drawn:	ROR	Checked:	AMC / CMQ	Approved:	AV	CAD File:	21 FO018 REV1	Scale:	1:800 @A3	Date:	19/01/2022	<table border="1"> <tr> <td>Client:</td> <td>McGinty O'Shea LTD</td> <td>Job No:</td> <td>21.171</td> </tr> <tr> <td>Project Title:</td> <td>Douglas FRS - PUBLIC REALM WORKS - SECTION 3</td> <td>Drawing No:</td> <td>21 FO018</td> </tr> <tr> <td>Drawing Title:</td> <td>TEMPORARY TRAFFIC MANAGEMENT LAYOUT FOR TWO - WAY FLOW & ALL STOP ON TOGHER ROAD TO FACILITATE PUBLIC REALM WOKS - SECTION 3</td> <td>Rev:</td> <td>0</td> </tr> </table>	Client:	McGinty O'Shea LTD	Job No:	21.171	Project Title:	Douglas FRS - PUBLIC REALM WORKS - SECTION 3	Drawing No:	21 FO018	Drawing Title:	TEMPORARY TRAFFIC MANAGEMENT LAYOUT FOR TWO - WAY FLOW & ALL STOP ON TOGHER ROAD TO FACILITATE PUBLIC REALM WOKS - SECTION 3	Rev:	0
RS	Design Issue for COMMENT or APPROVAL	19/01/22																																																									
Stat	Purpose of Issue																																																										
EQUIPMENT REQ'D	QTY																																																										
SIGNS	0																																																										
CONES	0																																																										
PED TAPE	0m																																																										
SITE FENCE	0m																																																										
LAMPS (if Req'd)	0																																																										
MASSGUARD	0m																																																										
DELTA BLOC	0m																																																										
Designed:	ROR																																																										
Drawn:	ROR																																																										
Checked:	AMC / CMQ																																																										
Approved:	AV																																																										
CAD File:	21 FO018 REV1																																																										
Scale:	1:800 @A3																																																										
Date:	19/01/2022																																																										
Client:	McGinty O'Shea LTD	Job No:	21.171																																																								
Project Title:	Douglas FRS - PUBLIC REALM WORKS - SECTION 3	Drawing No:	21 FO018																																																								
Drawing Title:	TEMPORARY TRAFFIC MANAGEMENT LAYOUT FOR TWO - WAY FLOW & ALL STOP ON TOGHER ROAD TO FACILITATE PUBLIC REALM WOKS - SECTION 3	Rev:	0																																																								