

LEGEND		TYPE B - WORKING SPACE - Resurfacing		LONGITUDINAL SAFETY ZONE (Min 5m)		PERMANENT ROAD ALIGNMENT - BUILT		SITE / PEDESTRIAN FENCE - Per Contract Specifications.		TRAFFIC CONES (LENGTH / SPACING) OR SAFETY BARRIER-		EXISTING PEDESTRIAN PATH (Min 1.2m Width maintained)		MANAGED PEDESTRIAN CROSSING - By A TMO		ACCESS TO BE MAINTAINED		SIGN SYMBOL			
DIVERSION DETAIL SEE 21 F0039		Closure Times: 1900 - 0600Hrs 10th Mon-Fri		CENTRA - Access to be closed out of working hours.		Centra		Sandown Crest		SPUR HILL		Working Space: To be phased to the opposite carriageway (SB) to complete resurfacing works & a min 3.0m lane maintained to maintain access to Brook & Palmbury - managed by TMO's.		Brook Ave		TOGHER RD		LOCAL ACCESS ONLY		Lehenaghmore Industrial Estate	

RESURFACING WORKS - Night-time Closure - PHASE 1

TOGHER RD

Robinscourt

O'Connell Court

Greenwood Estate S.

Bothar Dunta ROAD CLOSED

Tracht ar Mhalairt Sli DIVERTED TRAFFIC

Both Directions

Bothar Dunta ROAD CLOSED

Tracht ar Mhalairt Sli DIVERTED TRAFFIC

Bothar Dunta ROAD CLOSED

Tracht ar Mhalairt Sli DIVERTED TRAFFIC

Bothar Dunta ROAD CLOSED

Tracht ar Mhalairt Sli DIVERTED TRAFFIC

Bothar Dunta ROAD CLOSED

Tracht ar Mhalairt Sli DIVERTED TRAFFIC

Bothar Dunta ROAD CLOSED

Tracht ar Mhalairt Sli DIVERTED TRAFFIC

Bothar Dunta ROAD CLOSED

Tracht ar Mhalairt Sli DIVERTED TRAFFIC

Bothar Dunta ROAD CLOSED

Tracht ar Mhalairt Sli DIVERTED TRAFFIC

Bothar Dunta ROAD CLOSED

Tracht ar Mhalairt Sli DIVERTED TRAFFIC

Bothar Dunta ROAD CLOSED

Tracht ar Mhalairt Sli DIVERTED TRAFFIC

Bothar Dunta ROAD CLOSED

Tracht ar Mhalairt Sli DIVERTED TRAFFIC

Bothar Dunta ROAD CLOSED

Tracht ar Mhalairt Sli DIVERTED TRAFFIC

Bothar Dunta ROAD CLOSED

Tracht ar Mhalairt Sli DIVERTED TRAFFIC

Bothar Dunta ROAD CLOSED

Tracht ar Mhalairt Sli DIVERTED TRAFFIC

Bothar Dunta ROAD CLOSED

Tracht ar Mhalairt Sli DIVERTED TRAFFIC

Bothar Dunta ROAD CLOSED

Tracht ar Mhalairt Sli DIVERTED TRAFFIC

Bothar Dunta ROAD CLOSED

Tracht ar Mhalairt Sli DIVERTED TRAFFIC

Bothar Dunta ROAD CLOSED

Tracht ar Mhalairt Sli DIVERTED TRAFFIC

Bothar Dunta ROAD CLOSED

Tracht ar Mhalairt Sli DIVERTED TRAFFIC

Bothar Dunta ROAD CLOSED

Tracht ar Mhalairt Sli DIVERTED TRAFFIC

Bothar Dunta ROAD CLOSED

Tracht ar Mhalairt Sli DIVERTED TRAFFIC

Bothar Dunta ROAD CLOSED

Tracht ar Mhalairt Sli DIVERTED TRAFFIC

Bothar Dunta ROAD CLOSED

Tracht ar Mhalairt Sli DIVERTED TRAFFIC

Bothar Dunta ROAD CLOSED

Tracht ar Mhalairt Sli DIVERTED TRAFFIC

Bothar Dunta ROAD CLOSED

Tracht ar Mhalairt Sli DIVERTED TRAFFIC

Bothar Dunta ROAD CLOSED

Tracht ar Mhalairt Sli DIVERTED TRAFFIC

Bothar Dunta ROAD CLOSED

Tracht ar Mhalairt Sli DIVERTED TRAFFIC

Bothar Dunta ROAD CLOSED

Tracht ar Mhalairt Sli DIVERTED TRAFFIC

Bothar Dunta ROAD CLOSED

Tracht ar Mhalairt Sli DIVERTED TRAFFIC

Bothar Dunta ROAD CLOSED

Tracht ar Mhalairt Sli DIVERTED TRAFFIC

Bothar Dunta ROAD CLOSED

Tracht ar Mhalairt Sli DIVERTED TRAFFIC

Bothar Dunta ROAD CLOSED

Tracht ar Mhalairt Sli DIVERTED TRAFFIC

Bothar Dunta ROAD CLOSED

Tracht ar Mhalairt Sli DIVERTED TRAFFIC

Bothar Dunta ROAD CLOSED

Tracht ar Mhalairt Sli DIVERTED TRAFFIC

Bothar Dunta ROAD CLOSED

Tracht ar Mhalairt Sli DIVERTED TRAFFIC

Bothar Dunta ROAD CLOSED

Tracht ar Mhalairt Sli DIVERTED TRAFFIC

Bothar Dunta ROAD CLOSED

Tracht ar Mhalairt Sli DIVERTED TRAFFIC

Bothar Dunta ROAD CLOSED

Tracht ar Mhalairt Sli DIVERTED TRAFFIC

Bothar Dunta ROAD CLOSED

Tracht ar Mhalairt Sli DIVERTED TRAFFIC

Bothar Dunta ROAD CLOSED

Tracht ar Mhalairt Sli DIVERTED TRAFFIC

Bothar Dunta ROAD CLOSED

Tracht ar Mhalairt Sli DIVERTED TRAFFIC

Bothar Dunta ROAD CLOSED

Tracht ar Mhalairt Sli DIVERTED TRAFFIC

Bothar Dunta ROAD CLOSED

Tracht ar Mhalairt Sli DIVERTED TRAFFIC

Bothar Dunta ROAD CLOSED

Tracht ar Mhalairt Sli DIVERTED TRAFFIC

Bothar Dunta ROAD CLOSED

Tracht ar Mhalairt Sli DIVERTED TRAFFIC

Bothar Dunta ROAD CLOSED

Tracht ar Mhalairt Sli DIVERTED TRAFFIC

Bothar Dunta ROAD CLOSED

Tracht ar Mhalairt Sli DIVERTED TRAFFIC

Bothar Dunta ROAD CLOSED

Tracht ar Mhalairt Sli DIVERTED TRAFFIC

Bothar Dunta ROAD CLOSED

Tracht ar Mhalairt Sli DIVERTED TRAFFIC

Bothar Dunta ROAD CLOSED

Tracht ar Mhalairt Sli DIVERTED TRAFFIC

Bothar Dunta ROAD CLOSED

Tracht ar Mhalairt Sli DIVERTED TRAFFIC

Bothar Dunta ROAD CLOSED

Tracht ar Mhalairt Sli DIVERTED TRAFFIC

Bothar Dunta ROAD CLOSED

Tracht ar Mhalairt Sli DIVERTED TRAFFIC

Bothar Dunta ROAD CLOSED

Tracht ar Mhalairt Sli DIVERTED TRAFFIC

Bothar Dunta ROAD CLOSED

Tracht ar Mhalairt Sli DIVERTED TRAFFIC

Bothar Dunta ROAD CLOSED

Tracht ar Mhalairt Sli DIVERTED TRAFFIC

Bothar Dunta ROAD CLOSED

Tracht ar Mhalairt Sli DIVERTED TRAFFIC

Bothar Dunta ROAD CLOSED

Tracht ar Mhalairt Sli DIVERTED TRAFFIC

Bothar Dunta ROAD CLOSED

Tracht ar Mhalairt Sli DIVERTED TRAFFIC

Bothar Dunta ROAD CLOSED

Tracht ar Mhalairt Sli DIVERTED TRAFFIC

Bothar Dunta ROAD CLOSED

Tracht ar Mhalairt Sli DIVERTED TRAFFIC

Bothar Dunta ROAD CLOSED

Tracht ar Mhalairt Sli DIVERTED TRAFFIC

Bothar Dunta ROAD CLOSED

Tracht ar Mhalairt Sli DIVERTED TRAFFIC

Bothar Dunta ROAD CLOSED

Tracht ar Mhalairt Sli DIVERTED TRAFFIC

Bothar Dunta ROAD CLOSED

Tracht ar Mhalairt Sli DIVERTED TRAFFIC

Bothar Dunta ROAD CLOSED

Tracht ar Mhalairt Sli DIVERTED TRAFFIC

Bothar Dunta ROAD CLOSED

Tracht ar Mhalairt Sli DIVERTED TRAFFIC

Bothar Dunta ROAD CLOSED

Tracht ar Mhalairt Sli DIVERTED TRAFFIC

Bothar Dunta ROAD CLOSED

Tracht ar Mhalairt Sli DIVERTED TRAFFIC

Bothar Dunta ROAD CLOSED

Tracht ar Mhalairt Sli DIVERTED TRAFFIC

Bothar Dunta ROAD CLOSED

Tracht ar Mhalairt Sli DIVERTED TRAFFIC

Bothar Dunta ROAD CLOSED

Tracht ar Mhalairt Sli DIVERTED TRAFFIC

Bothar Dunta ROAD CLOSED

Tracht ar Mhalairt Sli DIVERTED TRAFFIC

Bothar Dunta ROAD CLOSED

Tracht ar Mhalairt Sli DIVERTED TRAFFIC

Bothar Dunta ROAD CLOSED

Tracht ar Mhalairt Sli DIVERTED TRAFFIC

Bothar Dunta ROAD CLOSED

Tracht ar Mhalairt Sli DIVERTED TRAFFIC

Bothar Dunta ROAD CLOSED

Tracht ar Mhalairt Sli DIVERTED TRAFFIC

Bothar Dunta ROAD CLOSED

Tracht ar Mhalairt Sli DIVERTED TRAFFIC

Bothar Dunta ROAD CLOSED

Tracht ar Mhalairt Sli DIVERTED TRAFFIC

Bothar Dunta ROAD CLOSED

Tracht ar Mhalairt Sli DIVERTED TRAFFIC

Bothar Dunta ROAD CLOSED

Tracht ar Mhalairt Sli DIVERTED TRAFFIC

Bothar Dunta ROAD CLOSED

Tracht ar Mhalairt Sli DIVERTED TRAFFIC

Bothar Dunta ROAD CLOSED

Tracht ar Mhalairt Sli DIVERTED TRAFFIC

Bothar Dunta ROAD CLOSED

Tracht ar Mhalairt Sli DIVERTED TRAFFIC

Bothar Dunta ROAD CLOSED

Tracht ar Mhalairt Sli DIVERTED TRAFFIC

Bothar Dunta ROAD CLOSED

Tracht ar Mhalairt Sli DIVERTED TRAFFIC

Bothar Dunta ROAD CLOSED

Tracht ar Mhalairt Sli DIVERTED TRAFFIC

Bothar Dunta ROAD CLOSED

Tracht ar Mhalairt Sli DIVERTED TRAFFIC

Bothar Dunta ROAD CLOSED

Tracht ar Mhalairt Sli DIVERTED TRAFFIC

Bothar Dunta ROAD CLOSED

Tracht ar Mhalairt Sli DIVERTED TRAFFIC

Bothar Dunta ROAD CLOSED

Tracht ar Mhalairt Sli DIVERTED TRAFFIC

Bothar Dunta ROAD CLOSED

Tracht ar Mhalairt Sli DIVERTED TRAFFIC

Bothar Dunta ROAD CLOSED

Tracht ar Mhalairt Sli DIVERTED TRAFFIC

Bothar Dunta ROAD CLOSED

Tracht ar Mhalairt Sli DIVERTED TRAFFIC

Bothar Dunta ROAD CLOSED

Tracht ar Mhalairt Sli DIVERTED TRAFFIC

Bothar Dunta ROAD CLOSED

Tracht ar Mhalairt Sli DIVERTED TRAFFIC

Bothar Dunta ROAD CLOSED

Tracht ar Mhalairt Sli DIVERTED TRAFFIC

Bothar Dunta ROAD CLOSED

Tracht ar Mhalairt Sli DIVERTED TRAFFIC

Bothar Dunta ROAD CLOSED

Tracht ar Mhalairt Sli DIVERTED TRAFFIC

Bothar Dunta ROAD CLOSED

Tracht ar Mhalairt Sli DIVERTED TRAFFIC

Bothar Dunta ROAD CLOSED

Tracht ar Mhalairt Sli DIVERTED TRAFFIC

Bothar Dunta ROAD CLOSED

Tracht ar Mhalairt Sli DIVERTED TRAFFIC

Bothar Dunta ROAD CLOSED

Tracht ar Mhalairt Sli DIVERTED TRAFFIC

Bothar Dunta ROAD CLOSED

Tracht ar Mhalairt Sli DIVERTED TRAFFIC

Bothar Dunta ROAD CLOSED

Tracht ar Mhalairt Sli DIVERTED TRAFFIC

Bothar Dunta ROAD CLOSED

Tracht ar Mhalairt Sli DIVERTED TRAFFIC

Bothar Dunta ROAD CLOSED

Tracht ar Mhalairt Sli DIVERTED TRAFFIC

Bothar Dunta ROAD CLOSED

Tracht ar Mhalairt Sli DIVERTED TRAFFIC

Bothar Dunta ROAD CLOSED

Tracht ar Mhalairt Sli DIVERTED TRAFFIC

Bothar Dunta ROAD CLOSED

Tracht ar Mhalairt Sli DIVERTED TRAFFIC

Bothar Dunta ROAD CLOSED

Tracht ar Mhalairt Sli DIVERTED TRAFFIC

Bothar Dunta ROAD CLOSED

Tracht ar Mhalairt Sli DIVERTED TRAFFIC

Bothar Dunta ROAD CLOSED

Tracht ar Mhalairt Sli DIVERTED TRAFFIC

Bothar Dunta ROAD CLOSED

Tracht ar Mhalairt Sli DIVERTED TRAFFIC

Bothar Dunta ROAD CLOSED

Tracht ar Mhalairt Sli DIVERTED TRAFFIC

Bothar Dunta ROAD CLOSED

Tracht ar Mhalairt Sli DIVERTED TRAFFIC

Bothar Dunta ROAD CLOSED

Tracht ar Mhalairt Sli DIVERTED TRAFFIC

Bothar Dunta ROAD CLOSED

Tracht ar Mhalairt Sli DIVERTED TRAFFIC

Bothar Dunta ROAD CLOSED

Tracht ar Mhalairt Sli DIVERTED TRAFFIC

Bothar Dunta ROAD CLOSED

Tracht ar Mhalairt Sli DIVERTED TRAFFIC

Bothar Dunta ROAD CLOSED

Tracht ar Mhalairt Sli DIVERTED TRAFFIC

Bothar Dunta ROAD CLOSED

Tracht ar Mhalairt Sli DIVERTED TRAFFIC

Bothar Dunta ROAD CLOSED

Tracht ar Mhalairt Sli DIVERTED TRAFFIC

Bothar Dunta ROAD CLOSED

Tracht ar Mhalairt Sli DIVERTED TRAFFIC

Bothar Dunta ROAD CLOSED

Tracht ar Mhalairt Sli DIVERTED TRAFFIC

Bothar Dunta ROAD CLOSED

Tracht ar Mhalairt Sli DIVERTED TRAFFIC

Bothar Dunta ROAD CLOSED

Tracht ar Mhalairt Sli DIVERTED TRAFFIC

Bothar Dunta ROAD CLOSED

Tracht ar Mhalairt Sli DIVERTED TRAFFIC

Bothar Dunta ROAD CLOSED

Tracht ar Mhalairt Sli DIVERTED TRAFFIC

Bothar Dunta ROAD CLOSED

Tracht ar Mhalairt Sli DIVERTED TRAFFIC

Bothar Dunta ROAD CLOSED

Tracht ar Mhalairt Sli DIVERTED TRAFFIC

Bothar Dunta ROAD CLOSED

Tracht ar Mhalairt Sli DIVERTED TRAFFIC

Bothar Dunta ROAD CLOSED

Tracht ar Mhalairt Sli DIVERTED TRAFFIC

Bothar Dunta ROAD CLOSED

Tracht ar Mhalairt Sli DIVERTED TRAFFIC

Bothar Dunta ROAD CLOSED

Tracht ar Mhalairt Sli DIVERTED TRAFFIC

Bothar Dunta ROAD CLOSED

Tracht ar Mhalairt Sli DIVERTED TRAFFIC

Bothar Dunta ROAD CLOSED

Tracht ar Mhalairt Sli DIVERTED TRAFFIC

Bothar Dunta ROAD CLOSED

Tracht ar Mhalairt Sli DIVERTED TRAFFIC

Bothar Dunta ROAD CLOSED

Tracht ar Mhalairt Sli DIVERTED TRAFFIC

Bothar Dunta ROAD CLOSED

Tracht ar Mhalairt Sli DIVERTED TRAFFIC

Bothar Dunta ROAD CLOSED

Tracht ar Mhalairt Sli DIVERTED TRAFFIC

Bothar Dunta ROAD CLOSED

Tracht ar Mhalairt Sli DIVERTED TRAFFIC

Bothar Dunta ROAD CLOSED

Tracht ar Mhalairt Sli DIVERTED TRAFFIC

Bothar Dunta ROAD CLOSED

Tracht ar Mhalairt Sli DIVERTED TRAFFIC

Bothar Dunta ROAD CLOSED

Tracht ar Mhalairt Sli DIVERTED TRAFFIC

Bothar Dunta ROAD CLOSED

Tracht ar Mhalairt Sli DIVERTED TRAFFIC

Bothar Dunta ROAD CLOSED

Tracht ar Mhalairt Sli DIVERTED TRAFFIC

Bothar Dunta ROAD CLOSED

Tracht ar Mhalairt Sli DIVERTED TRAFFIC

Bothar Dunta ROAD CLOSED

Tracht ar Mhalairt Sli DIVERTED TRAFFIC

Bothar Dunta ROAD CLOSED

Tracht ar Mhalairt Sli DIVERTED TRAFFIC

Bothar Dunta ROAD CLOSED

Tracht ar Mhalairt Sli DIVERTED TRAFFIC

Bothar Dunta ROAD CLOSED

Tracht ar Mhalairt Sli DIVERTED TRAFFIC

Bothar Dunta ROAD CLOSED

Tracht ar Mhalairt Sli DIVERTED TRAFFIC

Bothar Dunta ROAD CLOSED

Tracht ar Mhalairt Sli DIVERTED TRAFFIC

Bothar Dunta ROAD CLOSED

Tracht ar Mhalairt Sli DIVERTED TRAFFIC

Bothar Dunta ROAD CLOSED

Tracht ar Mhalairt Sli DIVERTED TRAFFIC

Bothar Dunta ROAD CLOSED

Tracht ar Mhalairt Sli DIVERT



SINGLE CARRIAGEWAY Level 1 (iii) Type B	
DESIGN PARAMETERS	50km/hr
Sign Size (mm)	600
Sign Visibility (m)	50
No. of Adv. Signs	2
Cumulative Sign Distance (m)	40
Distance between Signs (m)	20
Taper Rate	1 in 5
Cone Height (mm)	750
Taper Cone Spacing (m)	3
45° Taper Cone Spacing (m)	1
Longitudinal Cone Spacing (m)	3
Lamp Taper Spacing (m)	6
Lamp Longitudinal Spacing (m)	6
Lateral Safety Zone (m)	0.5
Longitudinal Safety Zone (m)	5
Min Lane Width (m)	3.0
Optimum Lane Width (m)	3.3
Two-way Road Width (m)m

once with all relevant authorities & contract requirements.
res & all pertinent factors risk assessed prior to installation.
n site and positioned so as not to hinder passage or visibility.
ted if they do not conflict with proposed signage, otherwise
porarily relocated
fic signage, traffic delineators and road marking are to be in
, 2019)
3.2.1 & all signs are to be reflective.
dvance warned of upcoming traffic management that may

ad so to hinder visibility splays to the passing public.
ner) pedestrian and vehicular, to be maintained at all times:
is or exit the site when is safe to do so, whilst displaying
to be identified & signed
ed on site



Placed at SA
- in both
Directions.

se.
13422:2004 and have a reflective sleeve.
ngitudinal to be provided and maintained at all times.
is to be maintained at all times (2.5m Lane to be Marshalled).
he site where necessary &/or assisted by additional TMO's if

he live traffic with fence to protect workers from entering the live
ace has not yet been laid, are to be applied on all approaches
0.4.2.8:

sed to
terial or
material, is
aches



WK072. Where traffic is exposed to an
unfinished surface, is to be placed from
both approaches

PEDESTRIAN MANAGEMENT:

Designated TMO'S are to manage the crossing of
Pedestrians at Diverted crossing points (Crossing points
are located near TMO's).
Ramps of Suitable suitable surface for vulnerable road
users are to be placed where pedestrian paths are closed &
diverted where dropped kerbs do not exist.

BUS STOP MANAGEMENT:

To be managed by the assigned TMO

COMPOUND LOCATION:

TTOS is to ensure that there is no conflict between
the compound site access signage & the
Proposed active traffic management Signage.

BUSINESS LIAISON:

All Business on Lehenaghmore to be notified of
Closure times & Detour route.

PEDESTRIAN DELINEATOR:

May be placed, as illustrated on footpaths opposite
the working space or alternately with the Cones /
barrier so to ensure that Pedestrians cannot enter
the working space or attempt to cross the road at a
point where a pedestrian crossing has been
closed.

McGinty O'Shea LTD

Douglas FRS -Togher Main Works Contract

TEMPORARY TRAFFIC MANAGEMENT LAYOUT FOR
SHUTTLE OPERATION (Type B) - & ROAD CLOSURE (Type B)
ON TOGHER RD - LEHENAGHMORE, CO.CORK (SHEET 2 OF 3)

Job No:
21.171

Drawing No:
21 FO040b

Rev:
0

RS	Design Issue for COMMENT or APPROVAL	06/09/22	Rev	Description	By	Date
Stat	Purpose of Issue					

EQUIPMENT REQ'D	QTY
SIGNS	0
CONES	0
PED TAPE	0m
SITE FENCE	0m
LAMPS (If Req)	0
MASSGUARD	0m
DELTA BLOC	0m

Traffic Management Design Ltd,
Unit 13,
Newcourt Shopping Centre,
Church Street, Cavan Town,
Co. Cavan, Ireland.
Tel: +353 (0) 49 4327588
Mob: +353 (0) 86 0442650
Web: www.trafficmanagementdesignltd.com
E-mail: roisino@tmdesign.ie

Designed: RO'R
Drawn: RO'R
Checked: AMC / CMQ
Approved: AV
CAD File: 21 FO39 REV0
Scale: 1:800 @A3
Date: 06/09/2022





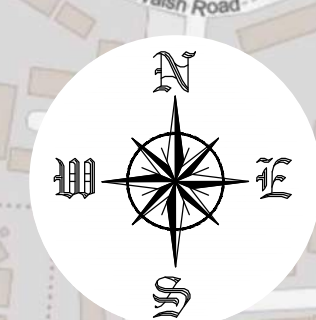

RESURFACING WORKS - Night-time Diversion

CLOSURE ADVANCE INFORMATION SIGNAGE:

1 Sign or a VMS to Be Placed either Side of the Closure Point - Min 5 days in **Advance of Closure Date.**
All businesses & residents within the local access zone are to be notified of Closure & dates

ROAD CLOSED
HERE
XX-XX-XX
XX-XX-XX

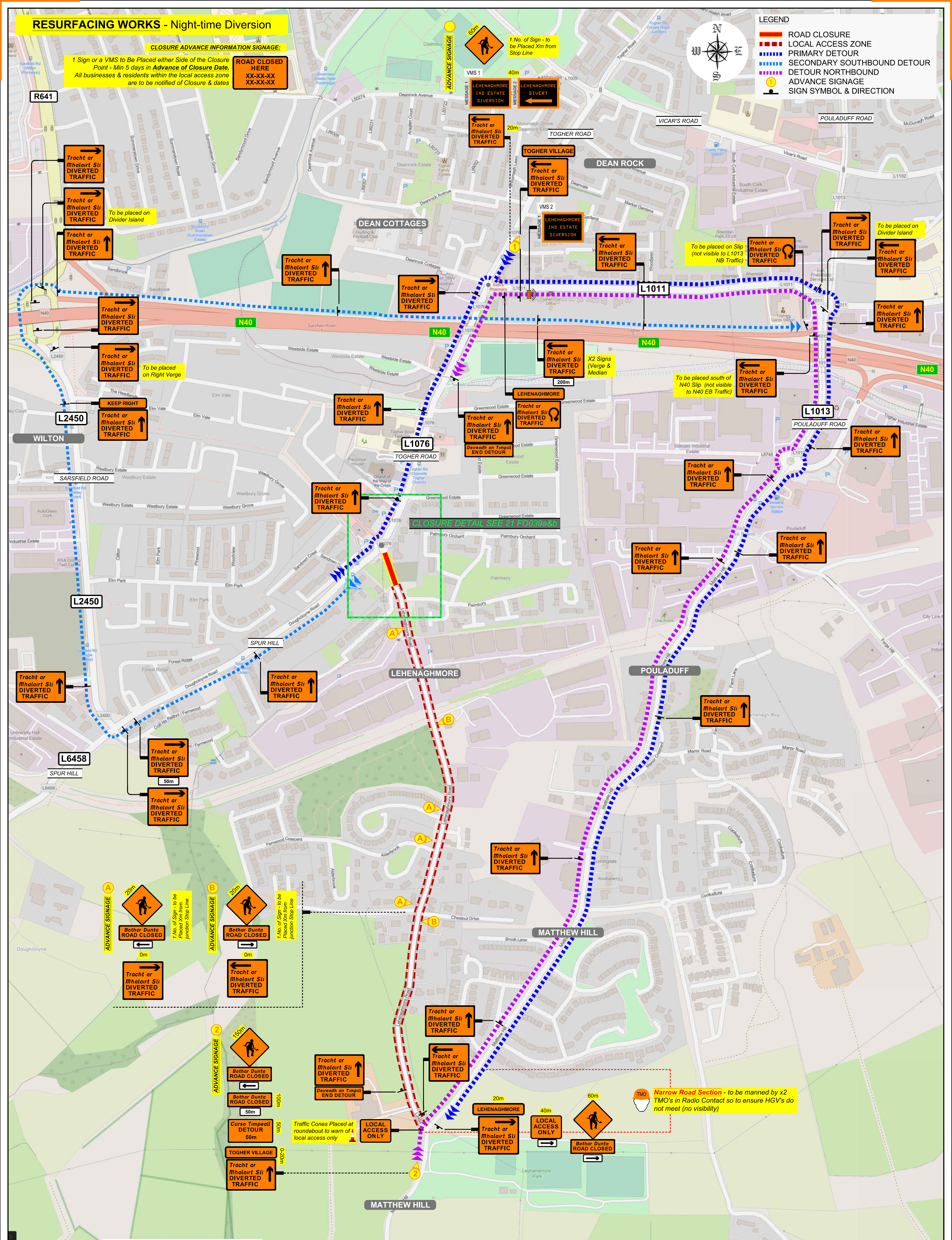

- ## LEGEND
- | | |
|---|-----------------------------|
|  | ROAD CLOSURE |
|  | LOCAL ACCESS ZONE |
|  | PRIMARY DETOUR |
|  | SECONDARY SOUTHBOUND DETOUR |
|  | DETOUR NORTHBOUND |
|  | ADVANCE SIGNAGE |
|  | SIGN SYMBOL & DIRECTION |

[illegible]